

Legend

- Boundary of Area to be Licensed
- Area to be Excavated
- Elevation, 1M Contour
- Elevation, Spot
- Parcel Fabric
- Surface Drainage Direction
- Existing Tree Cover
- Existing Fences
- Building/Structure
- Existing Entrance/Exit
- NVCA Regulation Line
- Setbacks, Metres
- Cross Sections
- Monitoring Well MW1-MW14
- Erosion Hazard Study Line
- Groundwater Contours

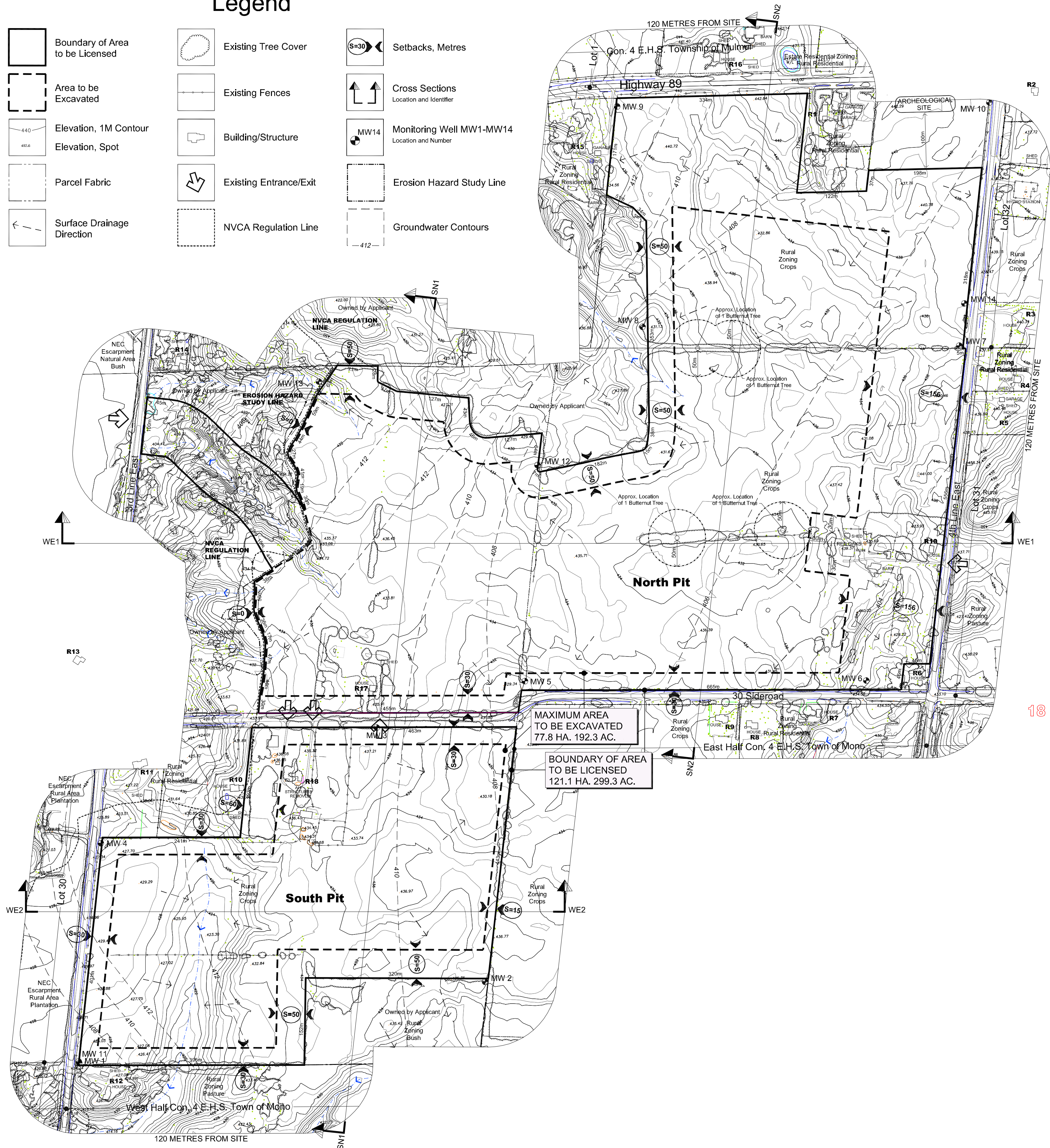

Draft
18 August, 2020

References

1. Topographic base mapping derived from 2010 airphoto as prepared by First Base Solutions Inc. Contour interval is 1 metre. Mapping supplemented with additional information from local planning documents.
2. Survey of Monitoring Well locations 1 to 14 by Van Harten Surveying and Engineering.
3. West boundary of northerly excavation area from *Erosion Hazards Study* by C.C. Tatham & Associates Ltd., June 16, 2015, January 19, 2018 and April 20, 2018.
4. *Traffic Review*, C.C. Tatham & Associates Ltd., June 2015 and July 05, 2017.
5. *Sound Impact Analysis Violet Hill Pit*, Valcoustics Canada Ltd., June 14, 2016 and July 06, 2017.
6. *Aggregate Investigation*, Geological Investigations, September 30, 2015.
7. *Agricultural Impact Assessment*, DBH Soil Services Inc., March 20, 2015.
8. *Air Quality Assessment*, Trinly Consultants Inc., March, 2016 and June 30, 2017.
9. *Stage 1 and 2 Archaeological Resource Assessment*, Archaeological Consultants and Contractors, January 14, 2015 and November 30, 2015.
10. Natural Environment Technical Report, Robin Craig Environmental Consultant, June 20, 2016 and April 20, 2018.
11. *Town of Mono Zoning Bylaw 78-1*, as Amended.
12. *Proposed Violet Hill Pit Combined Level 1 and 2 Hydrogeological Assessment*, Whitewater Hydrogeology Ltd., June, 2016.
13. *Visual Assessment*, Rollings Hyland Consulting, August 25, 2016.
14. *Planning Report*, Ron Davidson Land Use Planning Consultant Inc., June 29, 2016.
15. *Witness Statement on Planning*, Ron Davidson Land Use Planning Consultant Inc., June 24, 2020.
16. *Letter re: Updated Groundwater Elevation Data*, Whitewater Hydrogeology Ltd., June, 2020.
17. *Letter re: Soil Sampling for Rehabilitation to an Agricultural After Use*, DBH Soil Services Inc., April 30, 2020.



VIOLET HILL PIT

Part Lots 30, 31 & 32, Conc. 4 E.H.S.
Town of Mono
Dufferin County

Page 1 of 7 EXISTING FEATURES

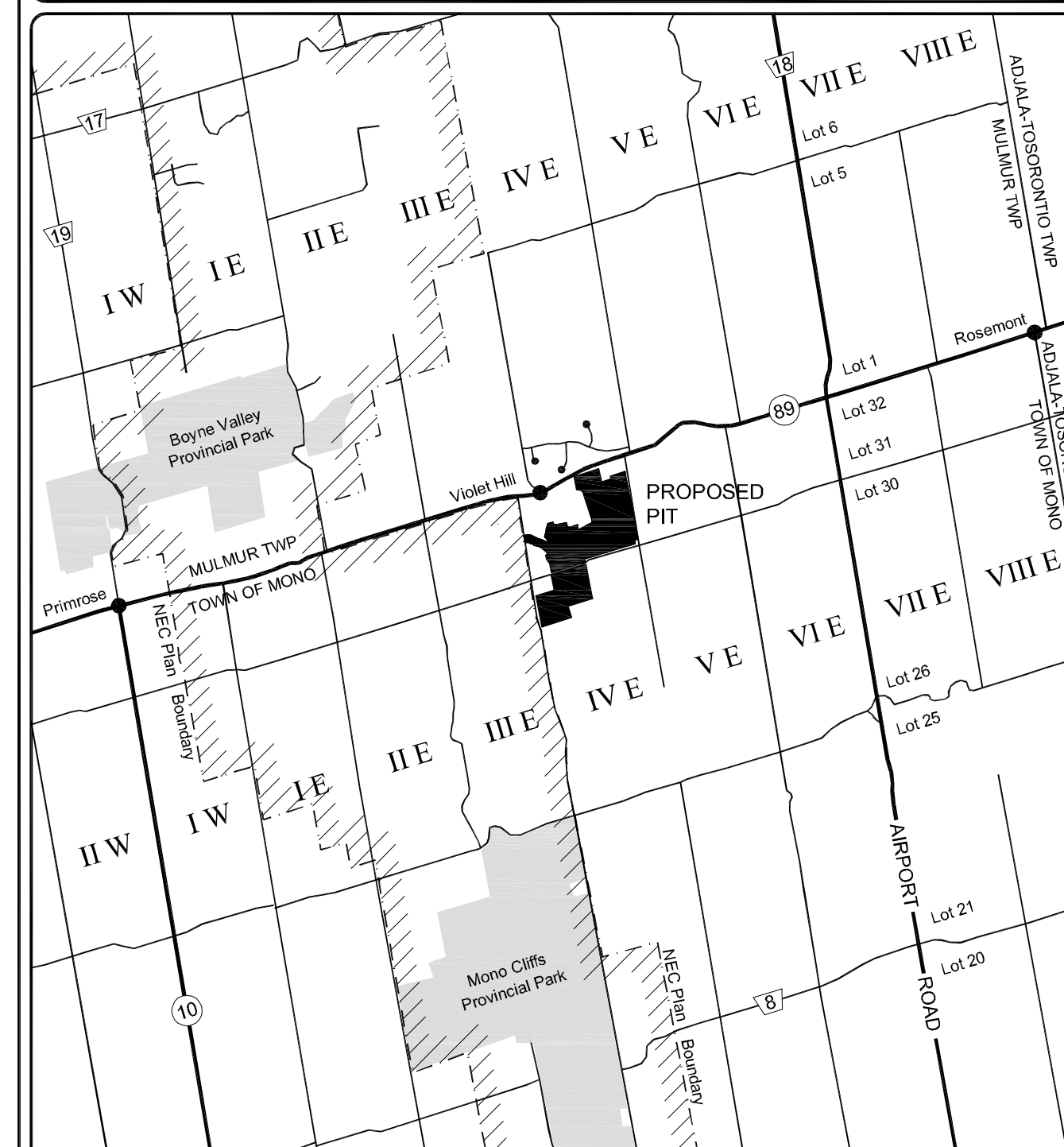

DRAWN: J.A.R. APPROVED: S.G. FILE: August 2020 Site Plans.dwg PLOTTED: 18 Aug. 2020	I ACKNOWLEDGE AND SHALL CARRY ON MY OPERATION IN ACCORDANCE WITH THE SITE PLAN UPON WHICH MY LICENCE IS BASED. GREENWOOD AGGREGATES LIMITED PER: _____ DATE: _____ SITE PLANS APPROVED BY: MINISTRY OF NATURAL RESOURCES AND FORESTRY DATE: _____	THIS SITE PLAN IS PREPARED UNDER THE AGGREGATE RESOURCES ACT FOR A CLASS A LICENCE, CATEGORY 3 JEFFREY A. ROLLINGS DATE: _____
--	--	--

No.	DATE	DESCRIPTION	APP'D
Amendments			

- ### Legend
- Boundary of Area to be Licensed
 - Area to be Excavated
 - Elevation, 1M Contour
 - Elevation, Spot
 - Parcel Fabric
 - Setbacks, Metres
 - Proposed Tree Screen
 - Existing Tree Cover
 - Existing Fences
 - Building/Structure Use and Receptor Number
 - Cross Sections Location and Identifier
 - Proposed Pit Floor Elevation M.A.S.L.
 - Direction of Excavation
 - Operating Areas A - E
 - Berm
 - Monitoring Well MW1-MW14
 - Entrance/Exit

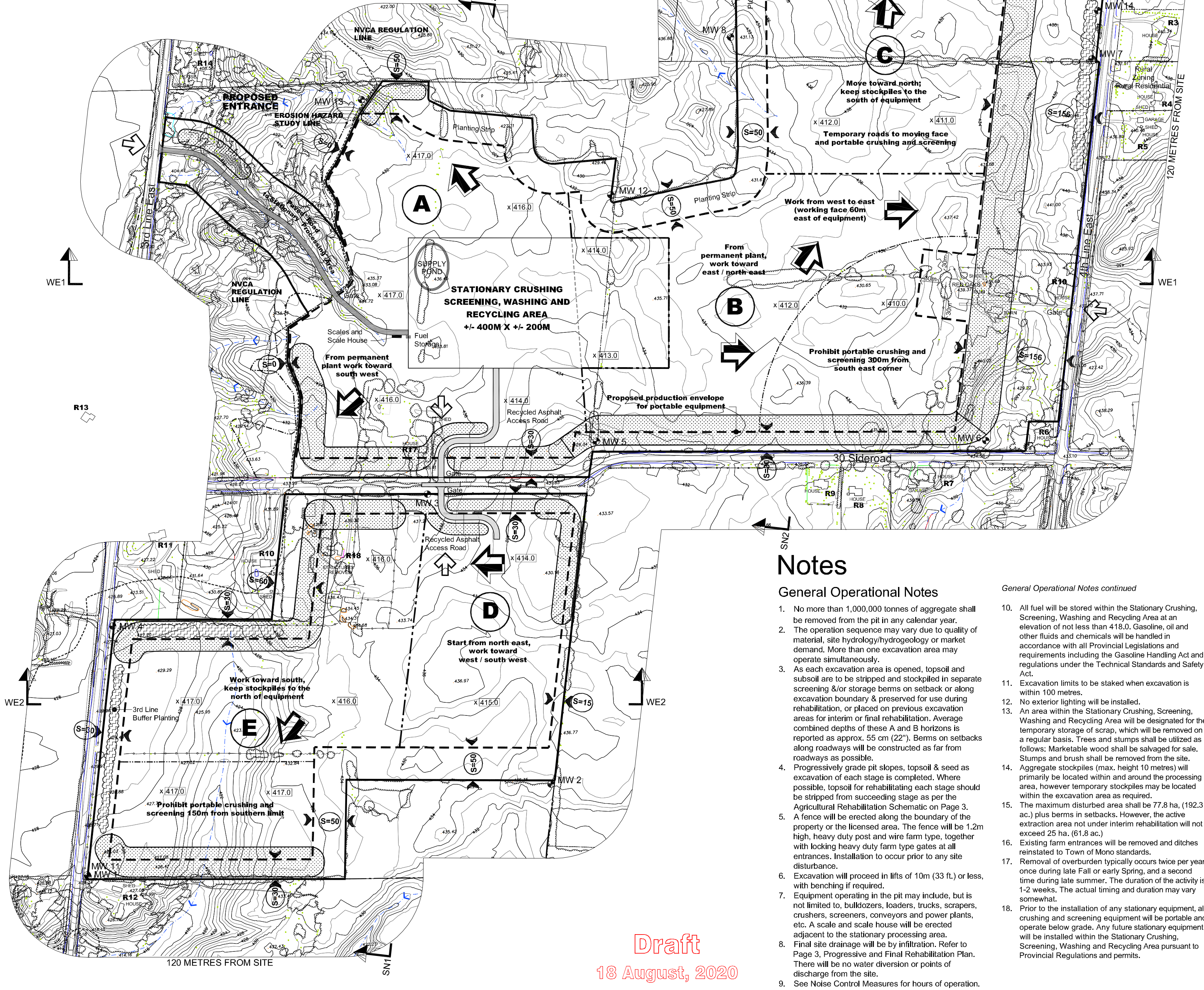

Notes

- #### General Operational Notes
- No more than 1,000,000 tonnes of aggregate shall be removed from the pit in any calendar year.
 - The operation sequence may vary due to quality of material, site hydrology/hydrogeology or market demand. More than one excavation area may operate simultaneously.
 - As each excavation area is opened, topsoil and subsoil are to be stripped and stockpiled in separate screening &/or storage berms on setback or along excavation boundary & preserved for use during rehabilitation, or placed on previous excavation areas for interim or final rehabilitation. Average combined depths of these A and B horizons is reported as approx. 55 cm (22"). Berms on setbacks along roadways will be constructed as far from roadways as possible.
 - Progressively grade pit slopes, topsoil & seed as excavation of each stage is completed. Where possible, topsoil for rehabilitating each stage should be stripped from succeeding stage as per the Agricultural Rehabilitation Schematic on Page 3.
 - A fence will be erected along the boundary of the property or the licensed area. The fence will be 1.2m high, heavy duty post and wire farm type, together with locking heavy duty farm type gates at all entrances. Installation to occur prior to any site disturbance.
 - Excavation will proceed in lifts of 10m (33 ft) or less, with benching if required.
 - Equipment operating in the pit may include, but is not limited to, bulldozers, loaders, trucks, scrapers, crushers, screeners, conveyors and power plants, etc. A scale and scale house will be erected adjacent to the stationary processing area.
 - Final site drainage will be by infiltration. Refer to Page 3, Progressive and Final Rehabilitation Plan. There will be no water diversion or points of discharge from the site.
 - See Noise Control Measures for hours of operation.
- #### General Operational Notes continued
- All fuel will be stored within the Stationary Crushing, Screening, Washing and Recycling Area at an elevation of not less than 418.0. Gasoline, oil and other fluids and chemicals will be handled in accordance with all Provincial Legislations and requirements including the Gasoline Handling Act and regulations under the Technical Standards and Safety Act.
 - Excavation limits to be staked when excavation is within 100 metres.
 - No exterior lighting will be installed.
 - An area within the Stationary Crushing, Screening, Washing and Recycling Area will be designated for the temporary storage of scrap, which will be removed on a regular basis. Trees and stumps shall be utilized as Stumps and brush shall be removed from the site.
 - Aggregate stockpiles (max. height 10 metres) will be located within setbacks. However, the active extraction area not under interim rehabilitation will not exceed 25 ha. (61.8 ac.)
 - Existing farm entrances will be removed and ditches reinstated to Town of Mono standards.
 - Removal of overburden typically occurs twice per year: once during late Fall or early Spring, and a second time during late summer. The duration of the activity is 1-2 weeks. The actual timing and duration may vary somewhat.
 - Prior to the installation of any stationary equipment, all crushing and screening equipment will be portable and operate below grade. Any future stationary equipment will be installed within the Stationary Crushing, Screening, Washing and Recycling Area pursuant to Provincial Regulations and permits.
 11. Excavation limits to be staked when excavation is within 100 metres.
 - No exterior lighting will be installed.
 - An area within the Stationary Crushing, Screening, Washing and Recycling Area will be designated for the temporary storage of scrap, which will be removed on a regular basis. Trees and stumps shall be utilized as Stumps and brush shall be removed from the site.
 - Aggregate stockpiles (max. height 10 metres) will be located within setbacks. However, the active extraction area not under interim rehabilitation will not exceed 25 ha. (61.8 ac.)
 - Existing farm entrances will be removed and ditches reinstated to Town of Mono standards.
 - Removal of overburden typically occurs twice per year: once during late Fall or early Spring, and a second time during late summer. The duration of the activity is 1-2 weeks. The actual timing and duration may vary somewhat.
 - Prior to the installation of any stationary equipment, all crushing and screening equipment will be portable and operate below grade. Any future stationary equipment will be installed within the Stationary Crushing, Screening, Washing and Recycling Area pursuant to Provincial Regulations and permits.

- #### General Operational Notes continued
- Onsite material will be used to construct berms. However, approved top soil will be imported to aid in berm construction and ensure the total disturbed area not under interim rehabilitation does not exceed 25 hectares. The licensee must ensure that the top soil is tested at the source, before it is deposited on-site, to ensure that the material meets the Ministry of the Environment, Conservation and Parks (MOECP) criteria under Table 1 of MOECP's Soils, Ground Water and Sediment Standards for use under Part XV.1 of the Environmental Protection Act. Reference shall also be had to the On-Site and Excess Soil Management Regulation under the EPA. Sampling results will be provided to MNRF upon request. Documentation will also be provided to the Town of Mono and all imported top soil will comply with standards found in the Town of Mono Fill By-law. All imported top soil will be included in the maximum annual tonnage.
 - Material movement from Operating Areas D and E shall only be through Area A, and the main entrance. Site-to-site access shall be by a controlled crossing of 30 Sideroad with gates and stop signs.
 - Truck traffic will be restricted to "local deliveries only" on all roads bordering the license except for the designated haul route from the exit of the license to Hwy. 89 on 3rd Line.
 - Prior to licence surrender wells will be decommissioned in accordance with Ontario Regulation 903.
 - Prior to site preparation, the Greenwood Aggregates Spill Contingency Plan shall be updated to include the specific details of the Violet Hill Pit operations. The Spill Prevention and Mitigation Plan shall outline the material handling and storage protocols, mitigation and monitoring measures and spill response plan, (i.e. emergency contact procedures, including the Spills Action Centre, and response measures including containment and clean-up). All fuel handling will comply with the provincial Liquid Fuels Handling Code. This Plan shall be displayed in scalehouses at all times.

- #### Natural Heritage Mitigation
- The following actions are recommended and are included on the plans to mitigate and/or avoid natural features on and within 120m of the Greenwood Violet Hill Pit site.
- All rehabilitated areas and setbacks within the licence will be surveyed annually by an experienced professional to determine if individual or colonies of invasive species including the following listed species have become established:
- Glossy Buckthorn (*Rhamnus cathartica*)
 - Common Buckthorn (*Frangula alnus*)
 - Dog-strangling Vine (*Cynanchum rossicum*)
 - Black Dog-strangling Vine (*Cynanchum louiseae*)
 - Garlic Mustard (*Alliaria petiolata*)
 - Japanese Knotweed (*Polygonum cuspidatum*)
 - Phragmites or Common Reed (*Phragmites australis* subsp. australis)
 - Giant Hogweed (*Heracleum mantegazzianum*)
- If an individual or colony of any of the above listed species is found within the licence area the individual or colony will be eradicated if feasible. The eradication method and/or methods will be determined and implemented by an experienced professional and may include manual, mechanical and/or chemical means.
- #### Provincially Significant Wetlands
- The extraction limit will be set back a minimum of 150 m from the wetland boundary.
- #### Endangered and Threatened Species General
- The Species at Risk List for Ontario will be reviewed annually to determine if newly listed species are present or have the potential to be found within the extraction limit.
 - Prior to stripping the area to be cleared will be surveyed during appropriate survey time periods by a qualified professional for the presence of endangered and threatened species.
 - A report of the above described surveys will be kept on file at the pit site and will be provided to OMNRF if an endangered or threatened species is found.
 - If required, approvals/authorizations will be obtained under the Endangered Species Act and/or amendments made to the site plan as necessary.
- #### Butternut
- Each of the 30 known Butternut will be clearly marked and numbered to assist with future identification and the establishment of appropriate setbacks.
 - A minimum 50 m setback between the extraction limit and the drip line of the north woodland where 26 Butternut were found will be established and clearly marked.
 - A minimum 50 m setback will be established and clearly marked around the 4 known Butternut found within the proposed extraction limit.
 - Prior to any operational activities occurring within the licensed area, including building haul roads, the operator must demonstrate to the satisfaction of OMNRF, that Endangered Species Act requirements related to protecting Butternut and their habitat have been met.
 - This will be accomplished by:
 - Searching for Butternut in an area and within 50 m of an area where an operation is planned.
 - Conducting the searches during the growing season prior to commencing the operation by a qualified professional following OMNRF search protocols.
 - Marking clearly all Butternut found and protecting each within a 50 m setback.
 - Completing health assessments by a certified Butternut health assessor on all Butternut found during the above described searches.
 - Submitting the results of the Butternut health assessments to OMNRF within 30 days of completing the assessments.
 - Seeking appropriate authorization under the Endangered Species Act prior to removing or commencing any operation within 50 m of any Butternut.

- #### Natural Heritage Mitigation continued
- #### Bat Species
- Exclude the on site north and south woodlands and potential bat maternity habitats from the license area.
 - Ensure a minimum 30 m setback between the extraction limit and the drip lines of any woodland communally or on adjacent to the site.
 - Prior to removing any buildings and mature trees on the site the building/trees will be surveyed by a qualified professional for the presence of bats using current survey protocols.
 - A multi-chambered bat house will be constructed to create bat maternity habitat on or within 120m adjacent to the site.
- #### Significant Woodlands
- Exclude the north and south woodlands from the license area.
 - Ensure a minimum 50 m setback from the drip lines of all woodlands on the site and their adjacent components.
 - Implement dust control measures as required to protect vegetation and wildlife within woodlands.
 - The setback area adjacent to the north and south woodlands will be planted with native conifers such as White Spruce and Eastern White Pine to add to the diversity of the woodlands.
 - To ensure no negative impacts from dust, adhere to Dust Control Measures as outlined on Page 7 of the Site Plans.
- #### White Heath Aster
- Prior to extraction in Phase E, White Heath Aster (*Symphoricarpos plumosus*) will be searched for and if found, will be moved to a suitable area outside the extraction limit.
- #### Significant Wildlife Habitat
- #### Shrub/Early Successional Bird Breeding Habitat
- Exclude the natural vegetation communities including the cultural thickets along the west boundary of the licensed area from the extraction limit.
- #### Eastern Wood Pewee
- Exclude the north and south woodlands from the license area.
 - Ensure a minimum 50 m setback from the drip lines of all woodlands on the site and their adjacent components.
 - Implement dust control measures as required to protect vegetation and wildlife within woodlands.
- #### Fish Habitat
- Store fuel and maintain equipment in a fuel and maintenance area in accordance with Provincial legislation.
 - Prepare a Spills Response Plan that will be implemented and enforced to protect water quality.
 - Monitor groundwater as described in the "Proposed Violet Hill Pit Combined Level 1 Level 2 Hydrogeological Assessment" by Whitewater Hydrogeology Ltd., 2015.

- #### Noise Control Measures
- Hours of operation are 7:00 to 19:00 Monday to Friday. No operations shall take place on Sundays or statutory holidays.
 - Loading and shipping only is allowed beginning at 6:00 am Monday to Friday and 6:00 to 12:00 on Saturdays.
 - Receptor 17 must be vacated prior to commencing any extraction activities on the site.
 - Receptor 18 must be vacated prior to commencing extraction activities in the south portion of the site.
 - The sound emission level for all pieces of equipment used for construction activities including site preparation and rehabilitation must comply with the limits outlined in MOECP Publication NPC-115, "Construction Equipment".
 - Construction and rehabilitation activities can only occur during the daytime period (i.e. 0700 to 1900 hours), Monday to Friday. There is to be no construction on weekends or on Statutory holidays.
 - Berms must be constructed as shown on the Operations Plan. The berms can be constructed and removed according to the timings shown on the berm sequencing details. The berms required for any area must be constructed prior to extraction commencing within that area. For example, if extraction is to commence in Area A, then the berms required for Area A must be constructed prior to this extraction. If extraction were to move to Area B prior to extracting all of Area A, then the berms for both Areas A and B are required prior to extraction commencing in Area B.
 - Portable crushing and screening activities cannot occur within 300 m of the southeast corner of Area B and within 150 m of the southern limit of Area E. See Operations Plan.
 - Any permanent processing plant is to only operate within the area shown on the Operations Plan. The permanent processing plant is to be installed at a ground elevation of 422 masl to take advantage of the acoustical sequencing provided by having the plant below existing grade.
 - The direction of extraction is to be as shown on the Operations Plan.
 - The amount of extraction and the corresponding maximum sound emission levels are not to exceed the values indicated in the table below.

Variations from the Operational Standards

The following conditions illustrated on this plan vary from the requirements of the provincial standards that apply to licensed pits in Ontario:

Standard	Variation
5.1 Fences	Fence will be located on license boundary except at the entrance where it will follow the excavation limit.

Compliance Monitoring Program

Type	Number	Maximum Sound Emission Level at 15m Reference Distance (dBA)
Front End Loader at Extraction Face	1	75
Portable Crushing Plant at Extraction Face	1	84
Portable Screening Plant at Extraction Face	1	88
Dedicated On-Site Haul Trucks	4	82
Permanent Processing Plant which includes crushers, screens and a wash plant	1	90
Front End Loaders at the Permanent Processing Plant	2	75

Continuous water levels and temperatures shall be collected at all groundwater monitoring wells between March and November of each operating year.

- A selection of representative domestic water wells located within 500 m of the extraction area should be included in the groundwater monitoring program if they meet the selection criteria, which includes: wells are in compliance with Ontario Regulation 903 (as amended), are accessible, and constructed in the overburden aquifer. Prior to operations, water samples shall be collected from the participating domestic water wells and analyzed for general chemistry, major anions, oil and grease, and bacteria. Subsequent samples should be collected and analyzed on an annual basis at the end of the operational season (late fall). Continuous water levels should be collected from each domestic well and the data reviewed on a semi-annual basis.

Recycling

- Only unused surplus concrete produced at the licensee's ready mix concrete operation in Allison will be permitted for recycling on this site.
- The licensee will only import asphalt pavement for recycling to satisfy the requirements of the interim pit roads and blending with aggregate to meet specifications.
- All concrete and asphalt will be stored in the stationary processing area and the total combined volume stored onsite will not exceed 100 loads.
- All imported material coming into or leaving the site will be included in the maximum annual tonnage.
- Recyclable asphalt materials will not be stockpiled within:
 - 30m of any water body or man-made pond; or
 - 2m of the surface of the established water table.
- Removal of recycled aggregate is to be ongoing.
- Once the aggregate on site has been depleted there will be no further importation of recyclable materials permitted. Following final rehabilitation, all recycling operations must cease.

Greenwood

AGGREGATES LIMITED

205467 County Rd. 109, Amaranth ON L9W 0V1

VIOLET HILL PIT

Part Lots 30, 31 & 32, Conc. 4 E.H.S.
Town of Mono
Dufferin County

Page 2 of 7 OPERATIONS

Noise Control Measures

- If additional or other equipment is to be used on the site for non-construction or non-rehabilitation activities, the noise impact assessment needs to be updated and any mitigation recommendations implemented prior to this equipment operating on the site.
- One off-site noise audit measurement is to be completed at the commencement of the operation and after reaching a depth of elevation 422 masl, when processing is being done on the site to confirm the MOECP noise guideline limits are met. The audit measurements must be done by a qualified acoustical engineer.
 - All Greenwood owned equipment will be equipped with only broad band backup splay beepers to be used with the posted and enforced.
 - Residence R19 will remain occupied, but will not be adversely impacted by noise from pit operations.
 - All appropriate approvals under provincial requirements will be obtained.
 - In the event of a noise complaint, the complaint will be directed to the Site Supervisor, who will follow the protocols outlined on Page 7.

Archaeology

- Should deeply buried archaeological/heritage remains be found on the property during site preparation and/or extraction activities, the Ministry of Tourism and Culture should be notified immediately. In the event that human remains are encountered during site preparation and/or extraction, activities associated with the proposed development of the license area, the project proponent, Greenwood Aggregates Limited, should immediately contact the police, the Ministry of Tourism and Culture, and the Registrar or Deputy Registrar of the Cemeteries Regulation Unit of the Ministry of Consumer and Commercial Relations at 416-326-9382.

DRAWN: J.A.R. I ACKNOWLEDGE AND SHALL CARRY ON MY OPERATION IN ACCORDANCE WITH THE SITE PLAN UPON WHICH MY LICENSE IS BASED. GREENWOOD AGGREGATES LIMITED

APPROVED: S.G.

FILE: August 2020 Site Plans.dwg PER: DATE: DATE:

PLOTTED: 18 Aug. 2020

AMENDMENT NO. SITE PLANS APPROVED BY: JEFFREY A. ROLLINGS

MINISTRY OF NATURAL RESOURCES AND FORESTRY DATE: DATE:

No.	DATE	DESCRIPTION	APP'D
Amendments			

ORIGINAL SCALE 1:4,000 @ 22x34

ROLLINGS HYLAND CONSULTING

Caledon, Ontario 519.942.1961

CERTIFIED TO PREPARE SITE PLANS UNDER SECTION 8(4) OF THE AGGREGATE RESOURCES ACT

Draft
18 August, 2020

VIOLET HILL PIT
Part Lots 30, 31 & 32, Conc. 4 E.H.S.
Town of Mono
Dufferin County

Page 3 of 7
**PROGRESSIVE
AND FINAL
REHABILITATION**

Notes

- Progressive rehabilitation to occur within one full growing season after excavation of edges.
- Rehabilitation shall be undertaken in two phases. Following removal of the gravel layer (a minimum depth of 6 metres below existing grade), the surface will be lightly topsoiled and seeded. Edge rehabilitation down to the sand layer will be completed. Later, the sand layer will be removed, and final rehabilitation will be completed at final pit floor elevations.
- Pit floor to be excavated and graded to proposed rehabilitation elevations, or a minimum of five metres above the watertable. Topsoil and subsoil are to be progressively reclaimed from new stages and/or berms, in sequence, and placed on prepared (graded) areas. Average depth of topsoil and subsoil available for rehabilitation is approx 55cm (22").

Final rehabilitation soils will have compaction and fertility tested, prior to seeding, to confirm soil restoration and revegetation requirements.

All field areas to be rehabilitated in accordance with Ministry of Natural Resources and Forestry Guidelines for Rehabilitation to an Agricultural After Use.
- Complete edge rehabilitation by filling slopes with overburden reclaimed from storage berms, or where possible, with material stripped from current stages.
- After use of the proposed licence area is agricultural and open space conservation.
- Ultimate rehabilitation contours will vary as a result of actual site conditions, unsuitable granular material, and groundwater levels.
- Side Slopes will be seeded with a seed mix which contains native grass and forb species and avoids invasive species such as crown vetch.
- Site drainage will be by infiltration into the ground.
- Pre-extraction data will be collected to provide baseline information to assist in determining if restoration has been successful. Soil sampling for analysis of nutrients will be completed by following the Ontario Ministry of Agriculture, Food and Rural Affairs (OMAFRA) Factsheet "Soil Sampling and Analysis for Managing Crop Nutrients", Addex # 533 (March 2016) in conjunction with the recommendations in the OMAFRA document "Draft Agricultural Impact Assessment (AIA) Guidance Document (March 2018).

Soil sampling will be completed by a qualified person prior to any stripping of topsoil on a phase by phase basis. Soil sampling will only be completed once at the initial stage of a new phase and will not be completed prior to reopening an area for secondary extraction. Sampling results will be made available to the Town upon request.
- Imported concrete will not be used for backfill.

Draft
18 August, 2020

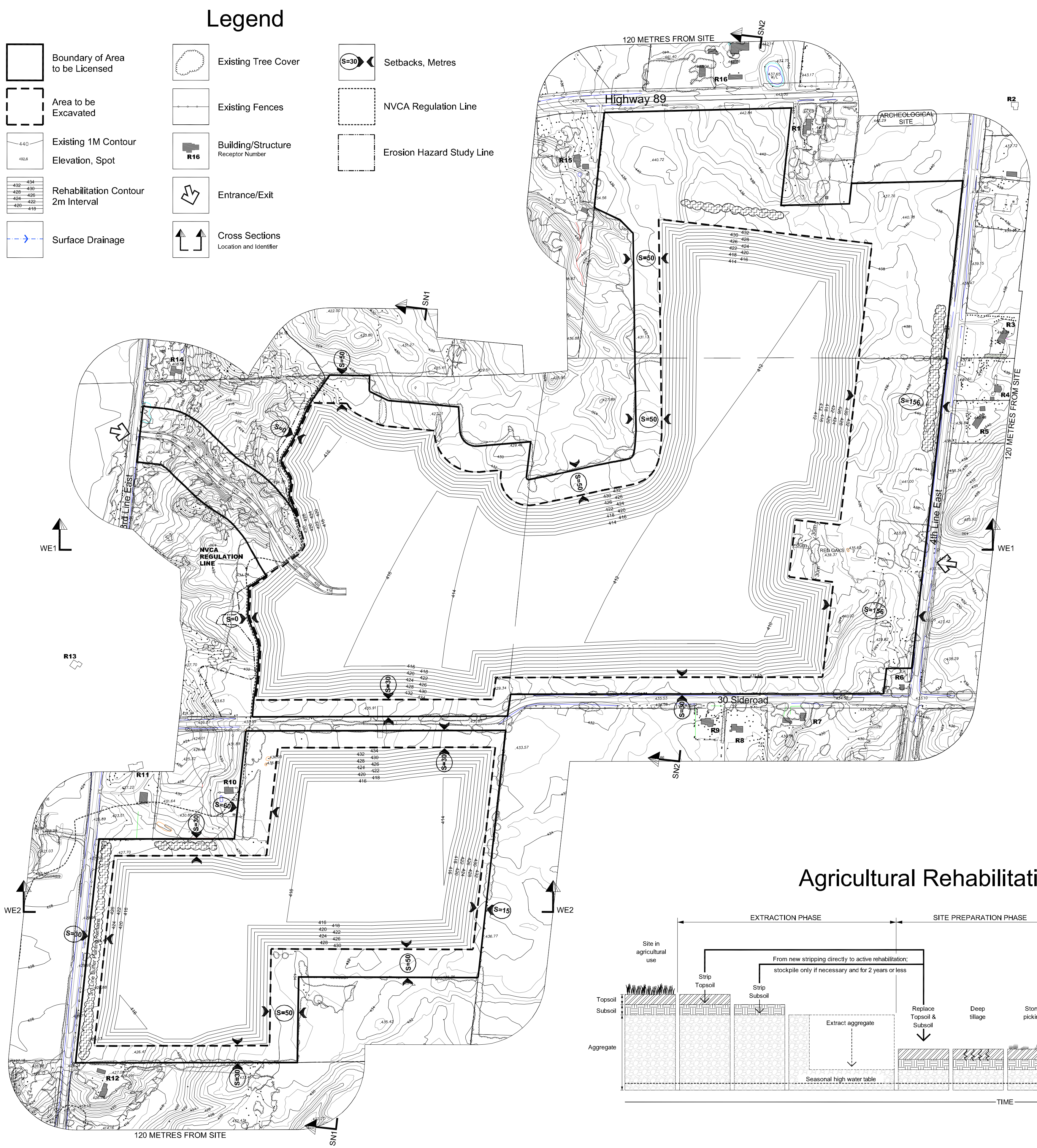

Agricultural Rehabilitation Sequence

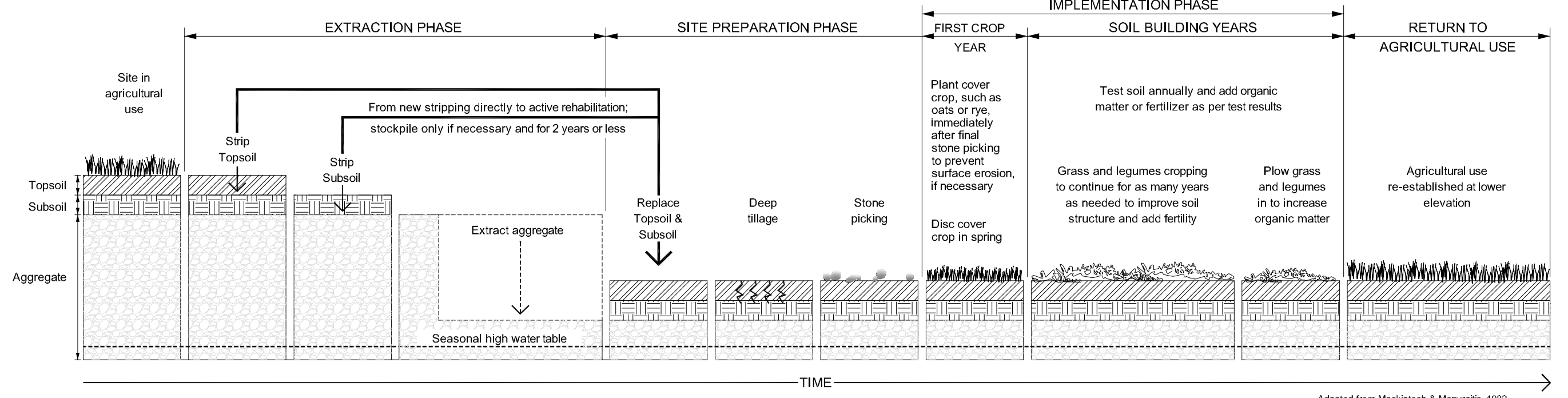

DRAWN: J.A.R. APPROVED: S.G. FILE: August 2020 Site Plans.dwg PLOTTED: 18 Aug. 2020	I ACKNOWLEDGE AND SHALL CARRY ON MY OPERATION IN ACCORDANCE WITH THE SITE PLAN UPON WHICH MY LICENCE IS BASED. GREENWOOD AGGREGATES LIMITED PER: _____ DATE: _____ SITE PLANS APPROVED BY: MINISTRY OF NATURAL RESOURCES AND FORESTRY DATE: _____	THIS SITE PLAN IS PREPARED UNDER THE AGGREGATE RESOURCES ACT FOR A CLASS A LICENCE, CATEGORY 3 JEFFREY A. ROLLINGS DATE: _____
AMENDMENT NO. <input type="text"/>	No. DATE DESCRIPTION APP'D	
Amendments		

Section WE1

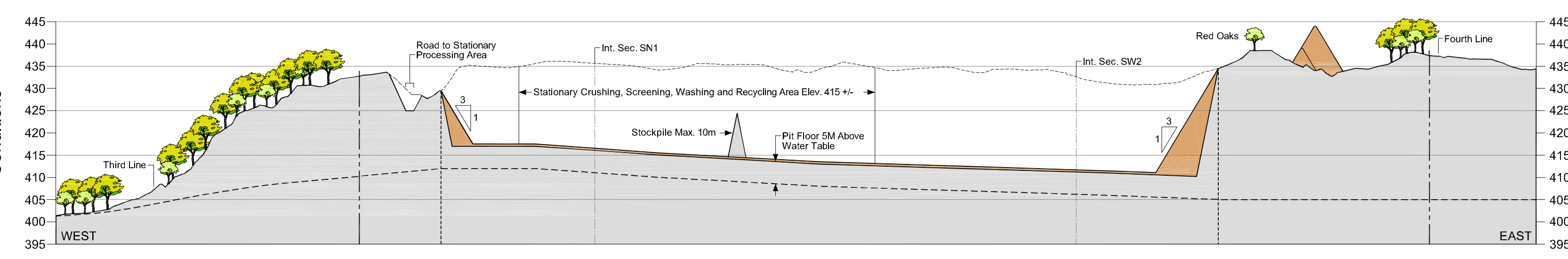
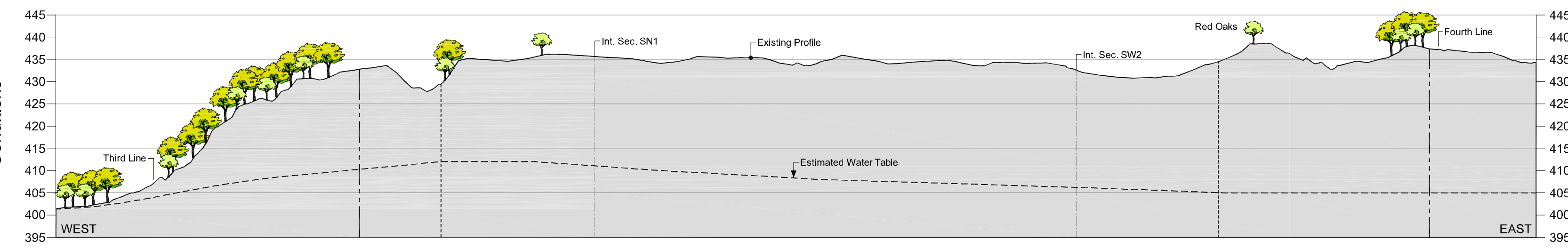

Section WE2

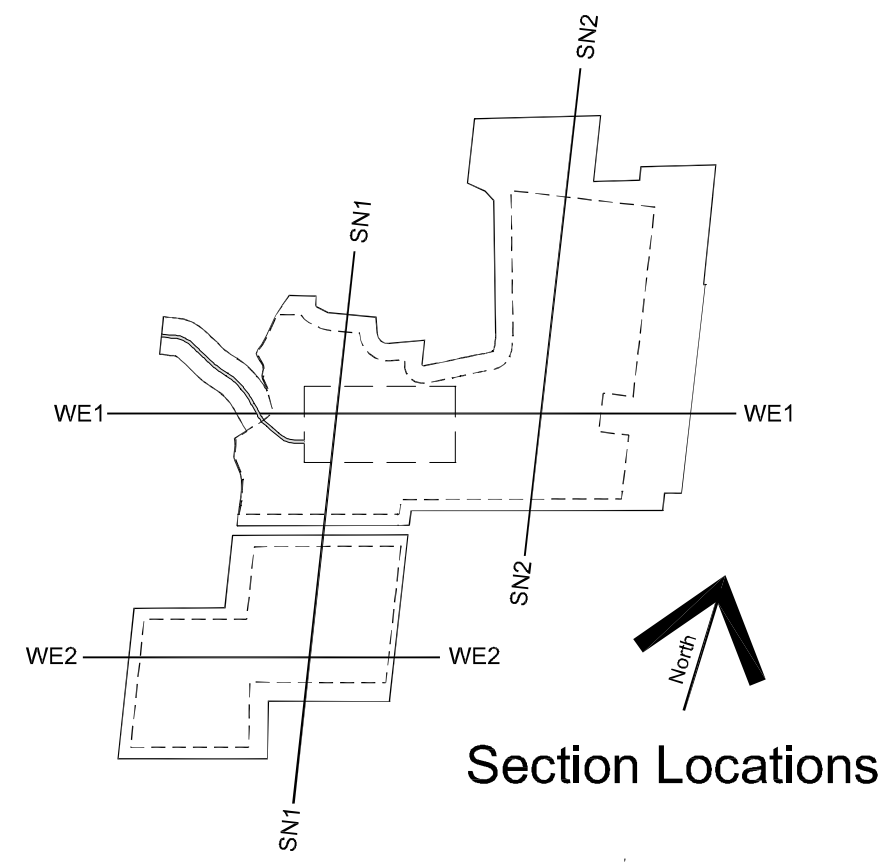
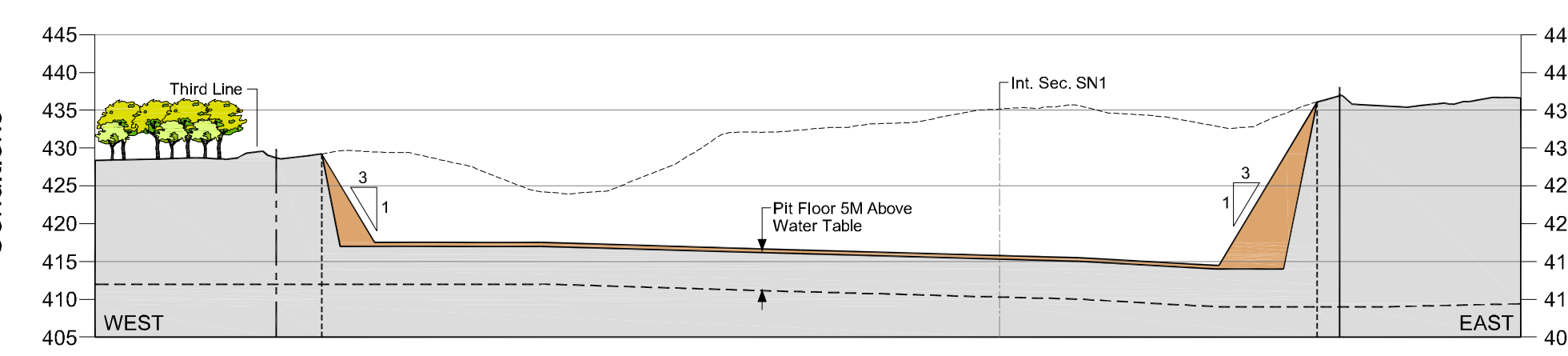
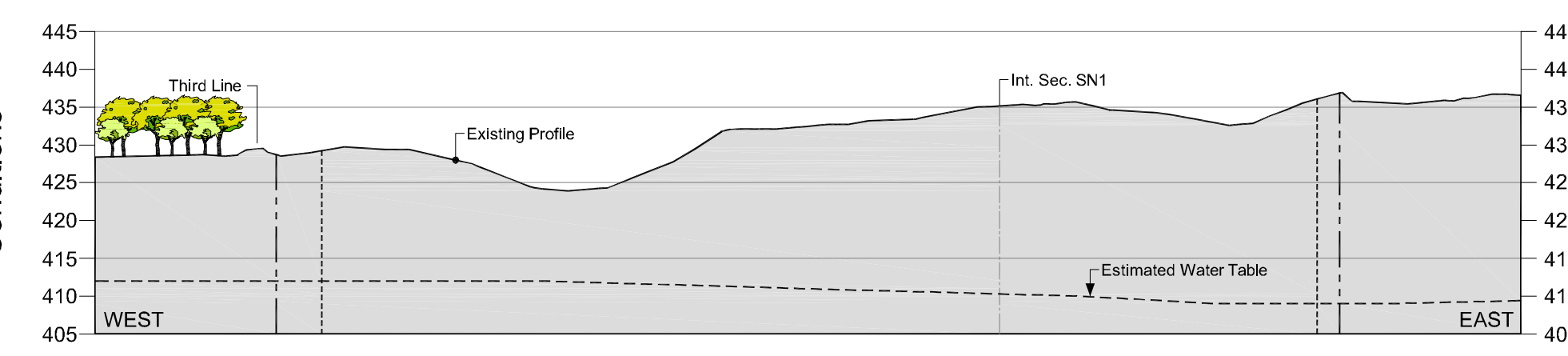

Section SN1

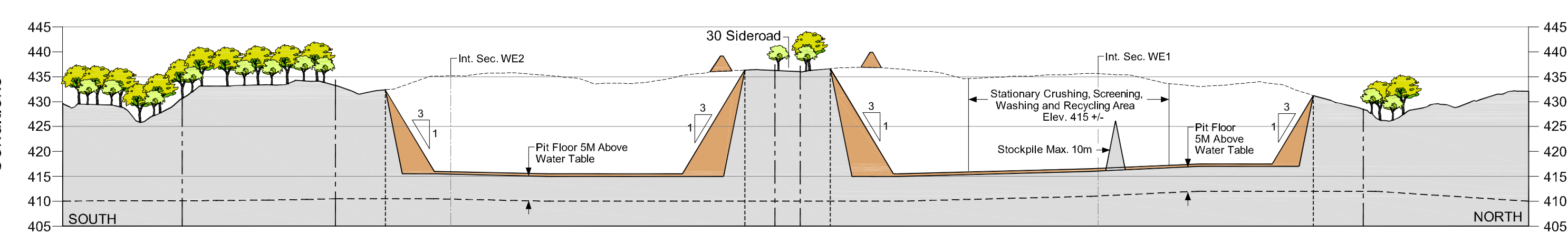
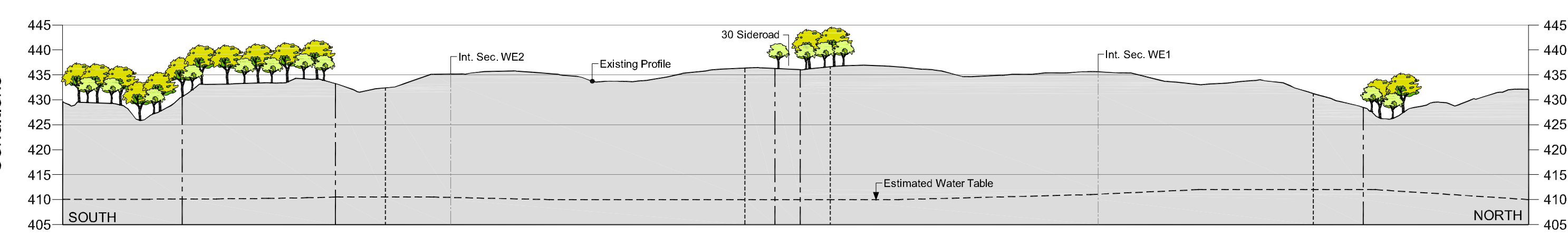

Section SN2

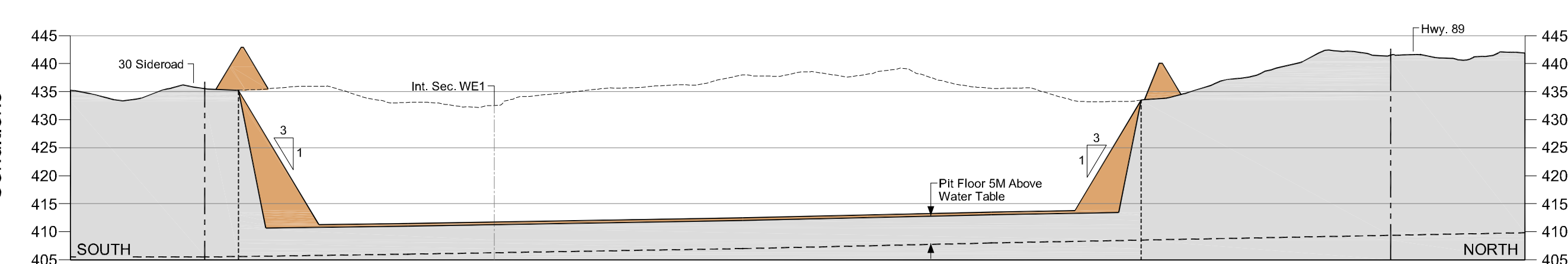
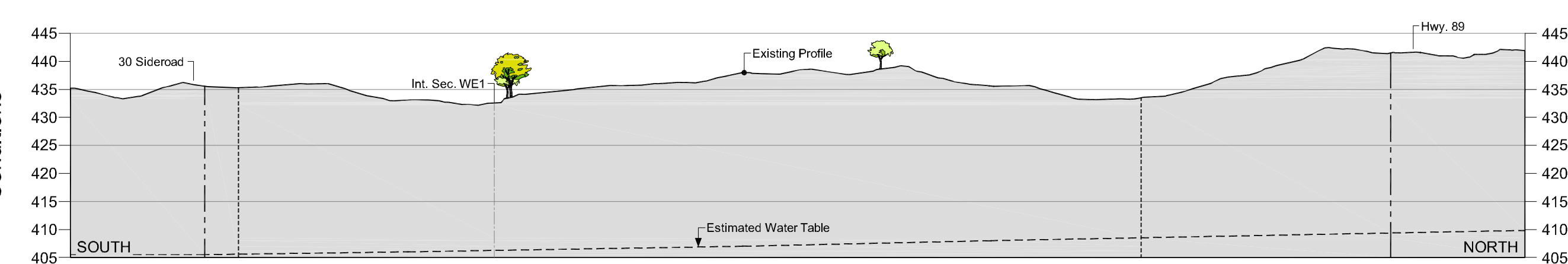

Legend

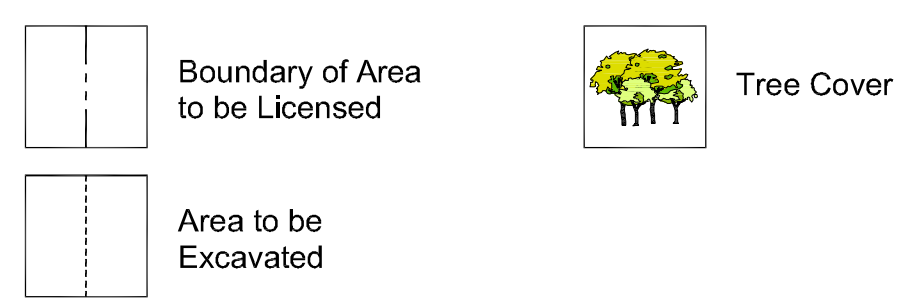

Notes

Draft
18 August, 2020



VIOLET HILL PIT

Part Lots 30, 31 & 32, Conc. 4 E.H.S.
Town of Mono
Dufferin County

Page 4 of 7
SECTIONS

Edge Standards

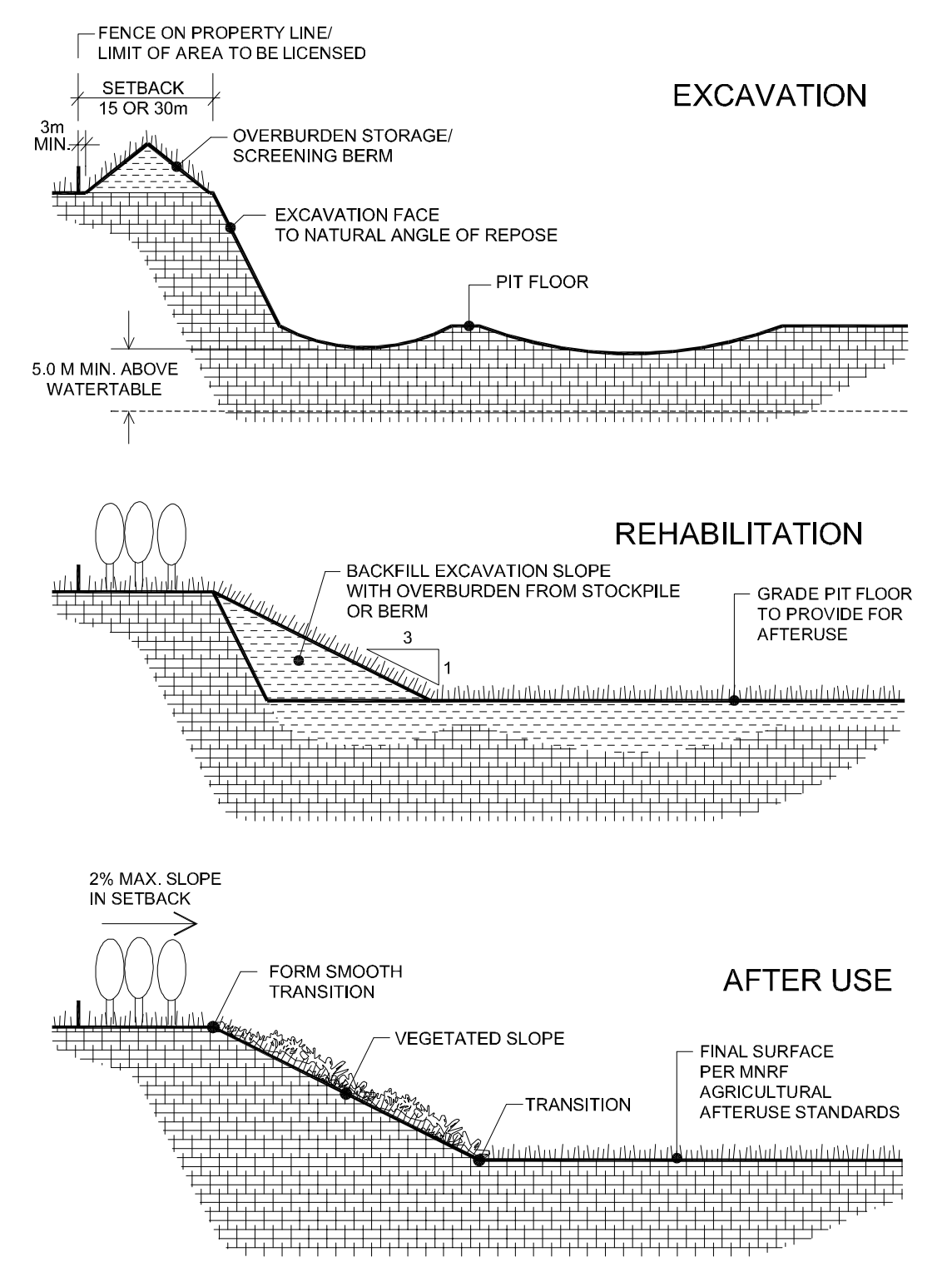

DRAWN: J.A.R.	I ACKNOWLEDGE AND SHALL CARRY ON MY OPERATION IN ACCORDANCE WITH THE SITE PLAN UPON WHICH MY LICENCE IS BASED.	THIS SITE PLAN IS PREPARED UNDER THE AGGREGATE RESOURCES ACT FOR A CLASS A LICENCE, CATEGORY 3
APPROVED: S.G.	GREENWOOD AGGREGATES LIMITED	
FILE: August 2020 Site Plans.dwg	PER: _____ DATE: _____	
PLOTTED: 18 Aug. 2020	SITE PLANS APPROVED BY: _____	JEFFREY A. ROLLINGS
	MINISTRY OF NATURAL RESOURCES AND FORESTRY	DATE: _____

No.	DATE	DESCRIPTION	APP'D
Amendments			

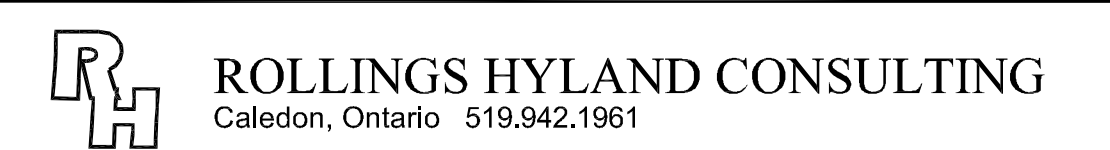
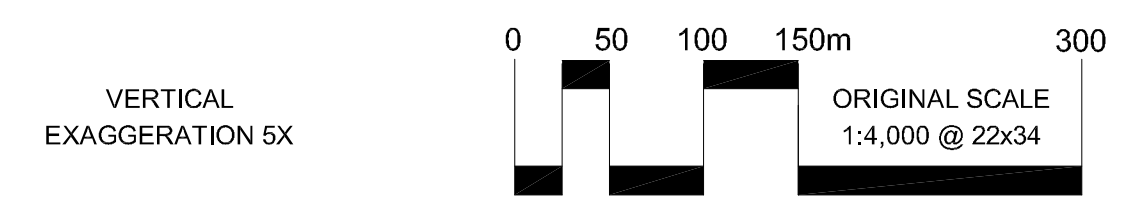

CERTIFIED TO PREPARE SITE PLANS UNDER SECTION 8(4) OF THE AGGREGATE RESOURCES ACT

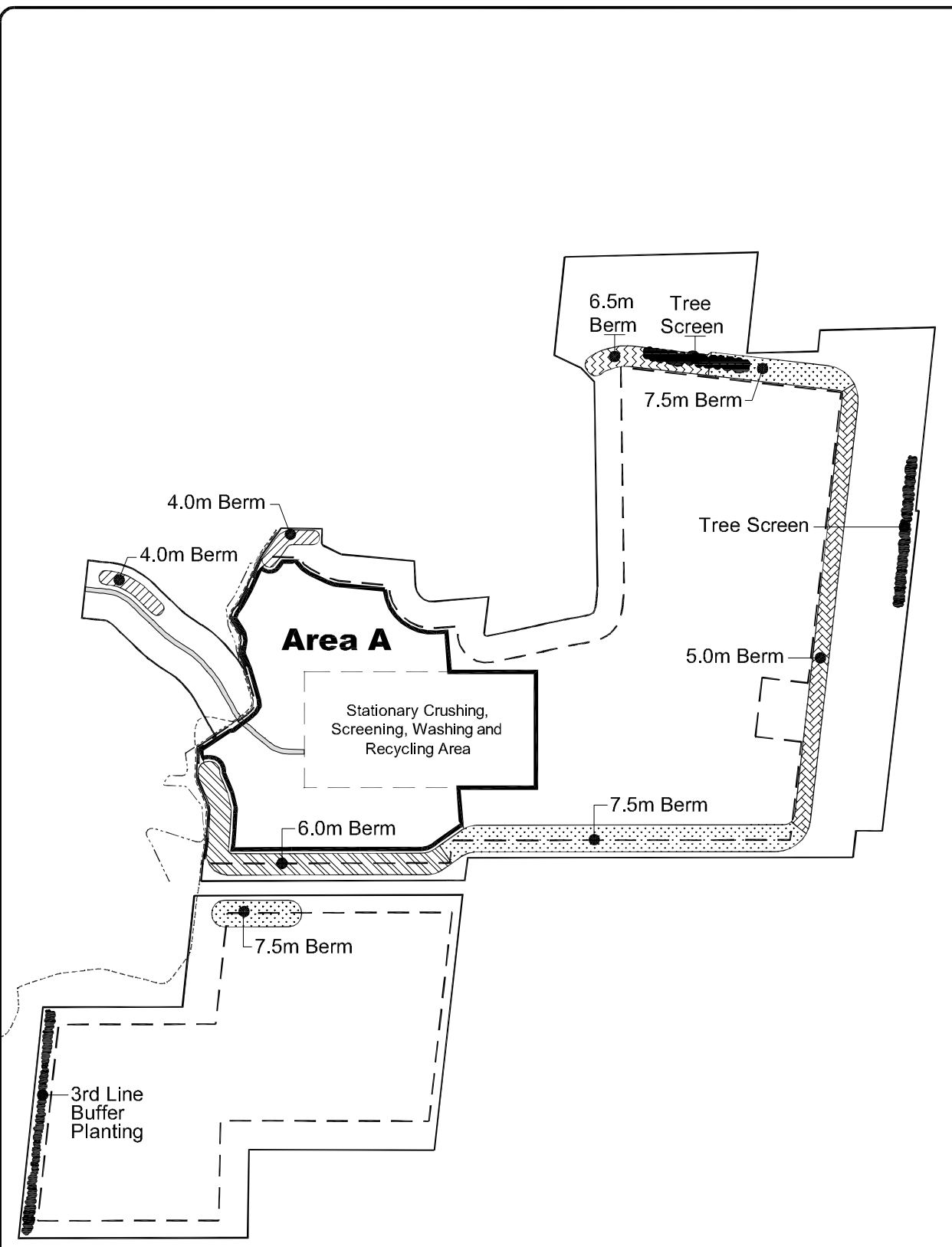

Berm Requirements - Area A

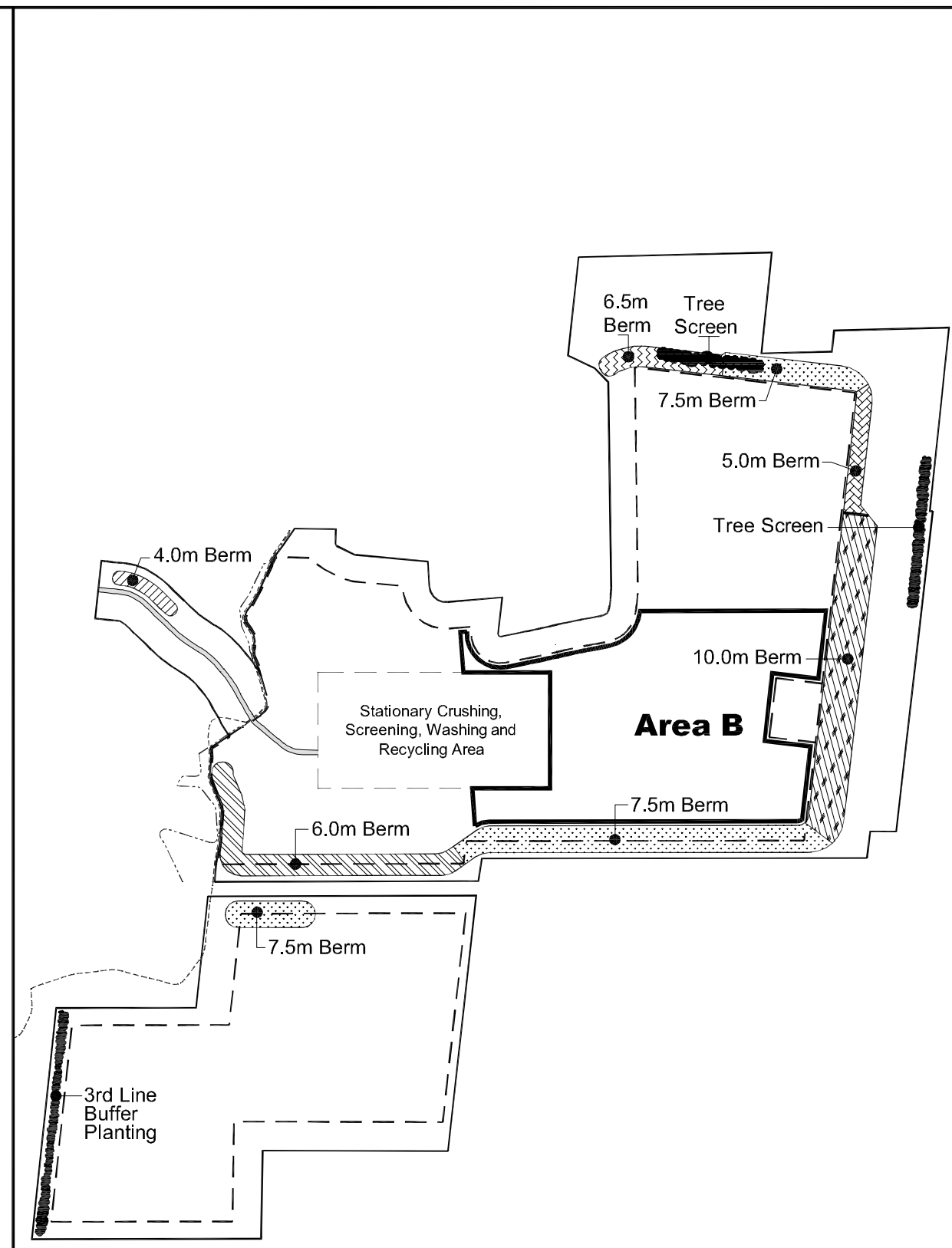

Berm Requirements - Area B

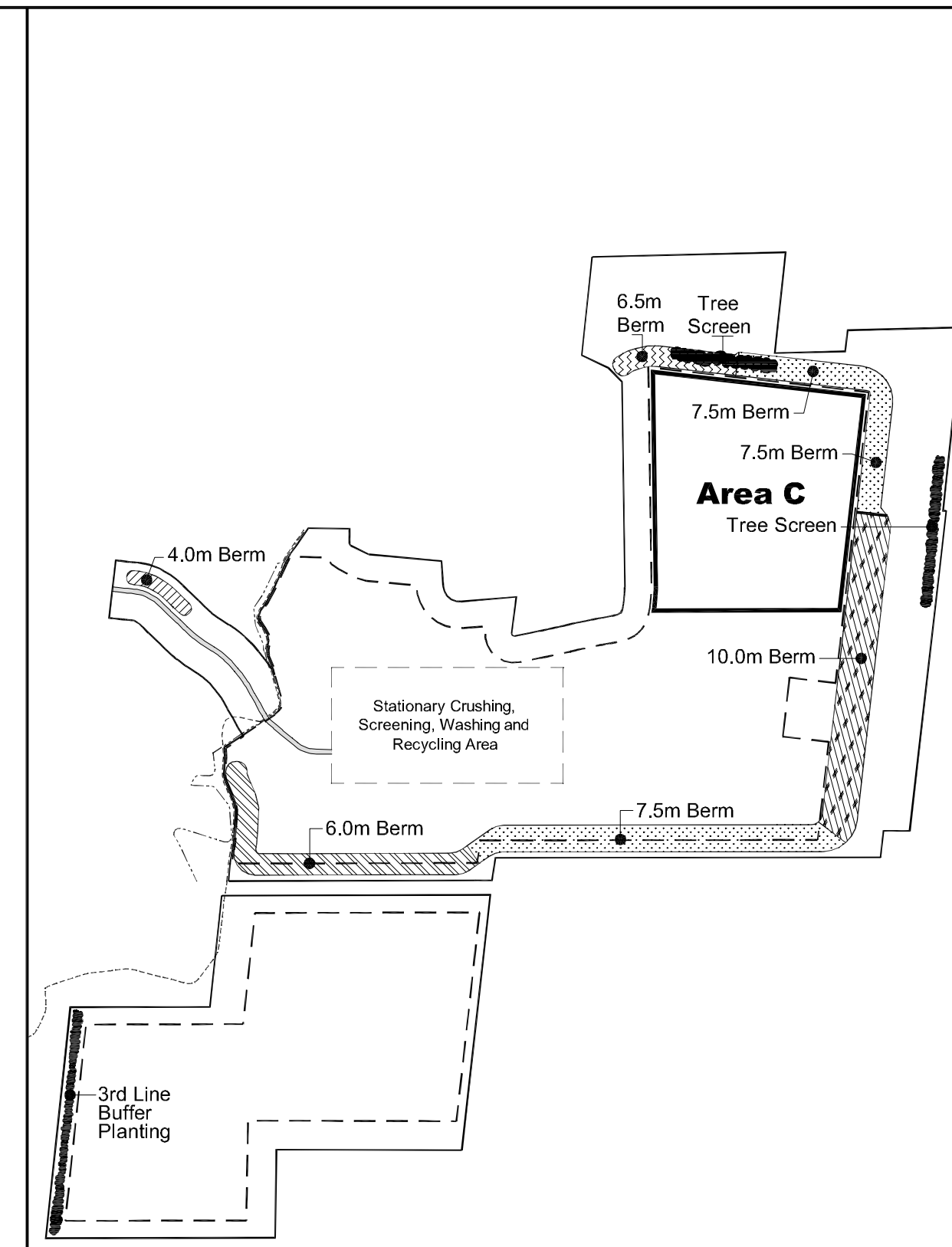

Berm Requirements - Area C

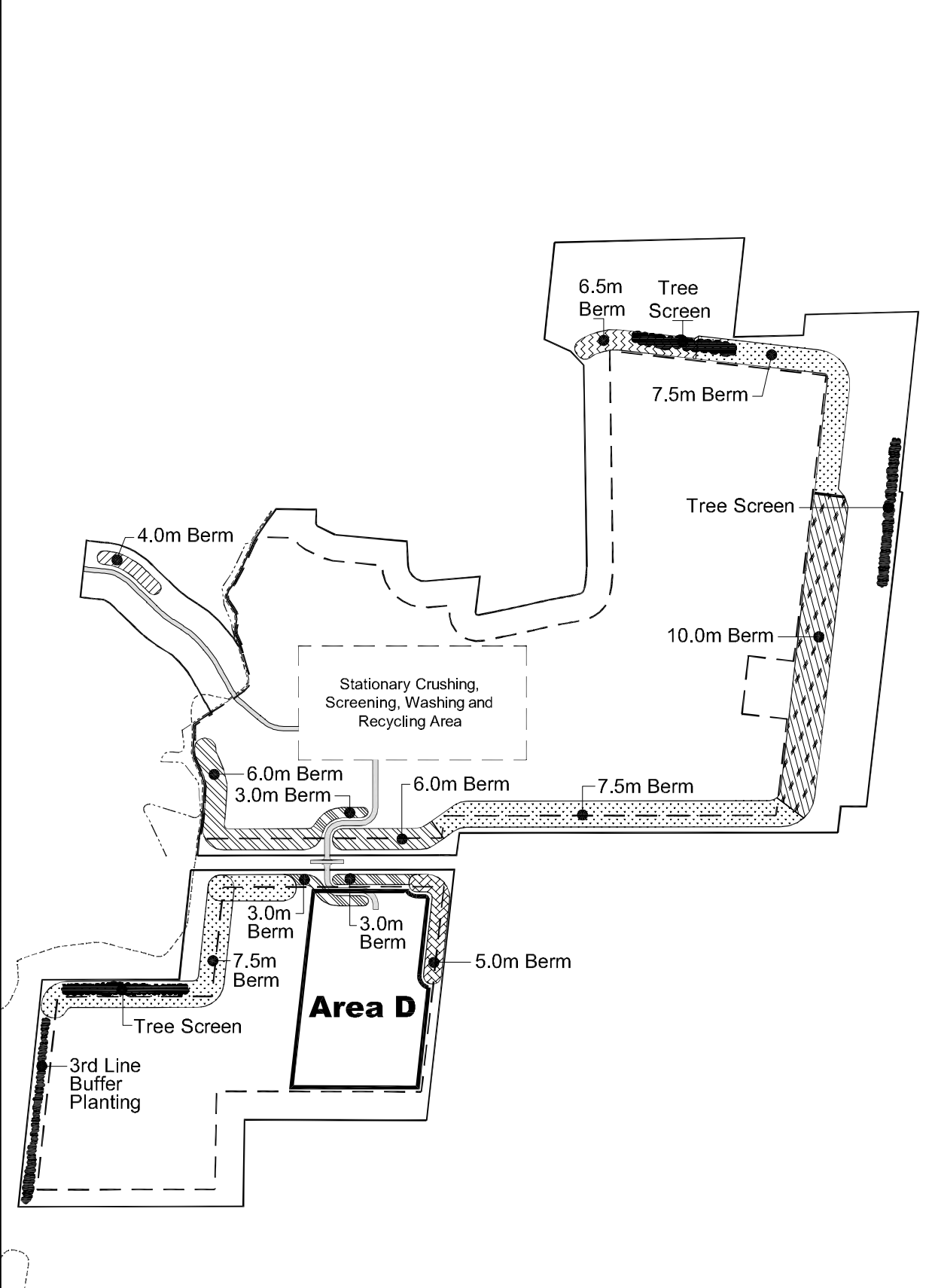

Berm Requirements - Area D

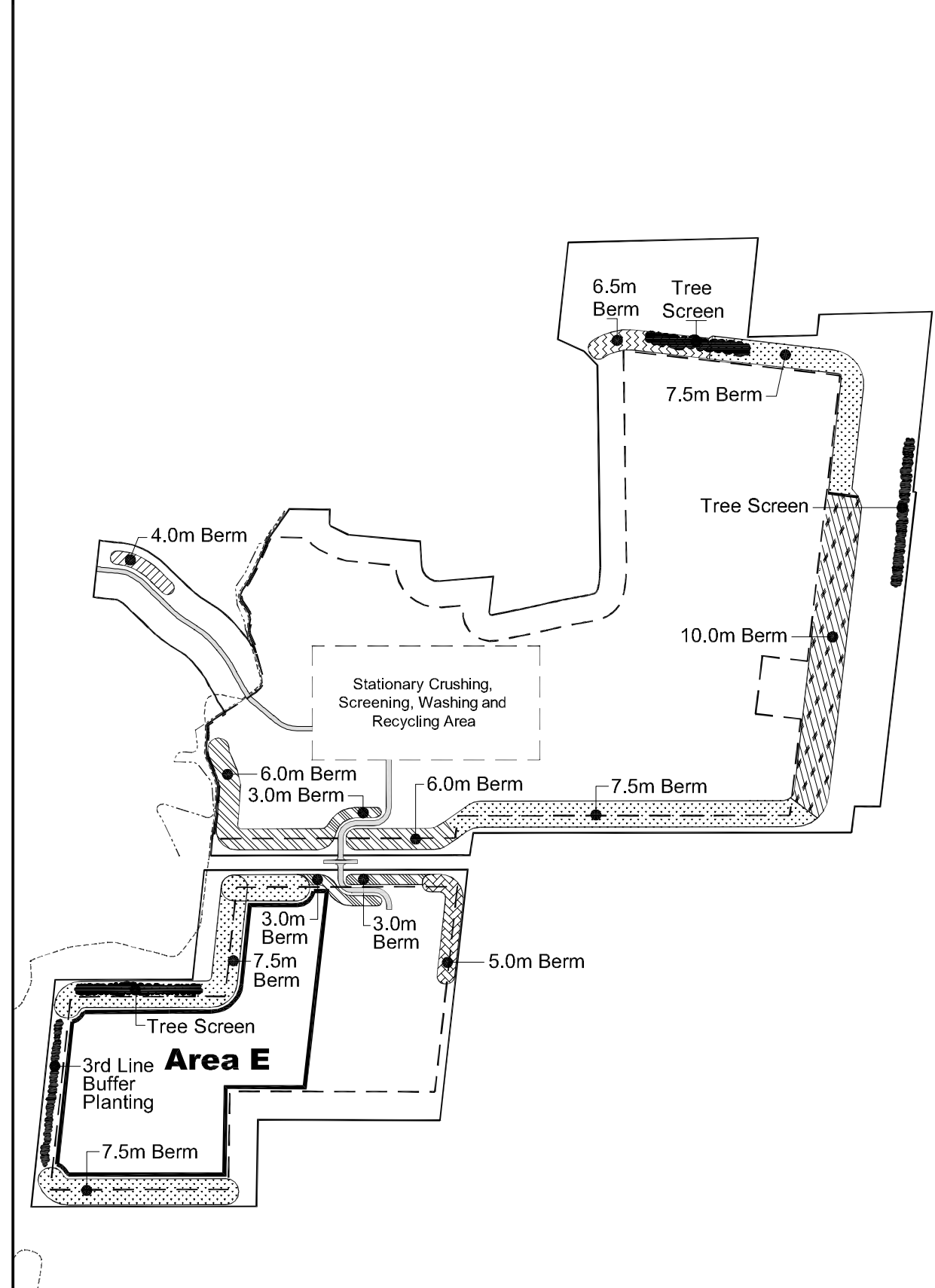

Berm Requirements - Area E

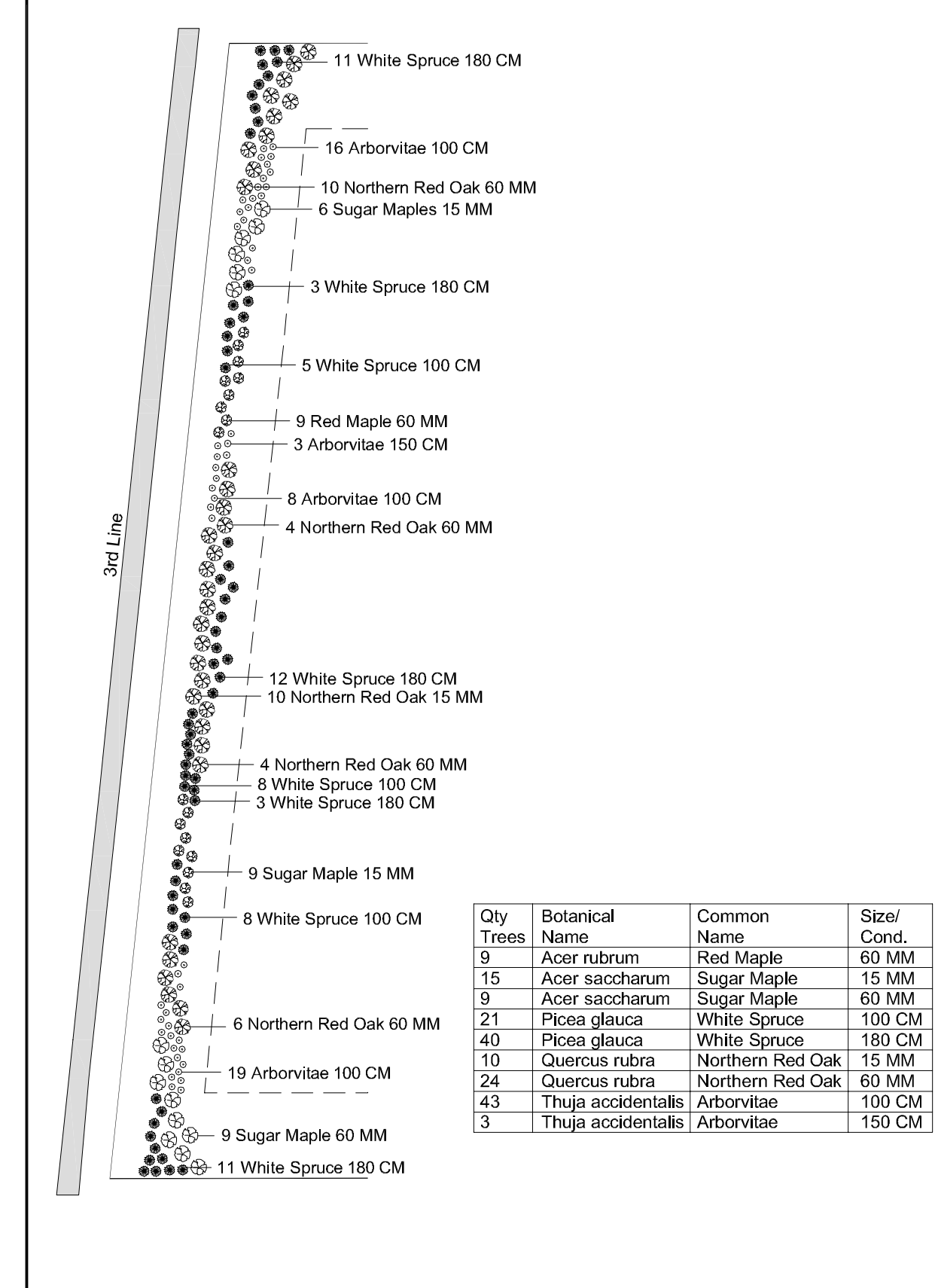

3rd Line Buffer Planting

1:2000 @ 22 x 34

Legend

- Boundary of Area to be Licensed
- Area to be Excavated
- NVCA Regulation Line
- Erosion Hazard Study Line
- 3.0m High Berm
- 4.0m High Berm
- 5.0m High Berm
- 6.0m High Berm
- 6.5m High Berm
- 7.5m High Berm
- 10.0m High Berm
- Tree Screen
- NVCA Regulation Line
- Erosion Hazard Study Line

Natural Heritage Mitigation For Access Road

Provincially Significant Wetlands on Adjacent Lands

- No land clearing or construction to occur from April 1 to July 31.
- Minimize area disturbance during land clearing and road construction.
- The haul road ditches will be armoured as required to prevent erosion.
- Surface water from the haul road will be retained on site to infiltrate into the ground water system.
- Erosion protection and surface water retention facilities will be designed to the satisfaction of the Town of Mono.
- Store fuel and maintain equipment in a fuel and maintenance area in accordance with Provincial legislation.
- Ensure all construction personnel are familiar with the Greenwood Aggregates corporate Spills Contingency Plan and the ten point "Spill Contingency Plan" described on page 2 of the Site Plans.

Endangered and Threatened Species

- Prior to stripping, the haul road area and within 120 metres will be surveyed for the presence of endangered and threatened species during appropriate survey time periods by a qualified professional.
- A report of the above described surveys will be kept on file at the pit site and will be provided to OMNR if an endangered or threatened species is found.
- If required, approvals/authorizations will be obtained under the Endangered Species Act and/or amendments made to the site plan as necessary.

Significant Wildlife Habitat

Shrub/Early Successional Bird Breeding Habitat

- Plant the 5.4 ha. setback land along the north boundary of the property with a native and non-native non-invasive meadow seed mixture.
- The restoration strategy will be prepared by a knowledgeable professional
- Native seed meadow mixes such as Ontario Seed Company mixes #8135 and/or #8145 will be planted initially to stabilize the site and create early successional meadow habitat. If these mixes are unavailable suitable alternatives will be used.
- Upland, medium height native shrubs will be planted in small clusters sparsely scattered over the site to develop shrub/early successional habitat. At least 3 species that are site suitable will be included in the plantings. These may include Chokecherry (*Prunus virginiana*), Serviceberry (*Amelanchier arborea*) and Staghorn Sumac (*Rhus typhina*). Depending on availability, other suitable species will be used.
- Planting specifications will include seed rate per ha., shrub planting pattern and stocking densities.
- Other aspects of the strategy will include shrub tending requirements, survival monitoring, acceptable survival rates and replacement policy.
- The restoration area will be monitored for invasive species and appropriate control measures implemented. Described in more detail on Page 2 Natural Heritage Mitigation.
- Naturalization of native shrubs and other native vegetation will also be an important component of the restoration strategy.

Rare Plants

- Prior to clearing for the haul road, the ditches and the surface water retention facility, the area will be surveyed for White Heath Aster (*Symphotrichum pilosum*) and Prane Cinquefoil (*Drymocallis arguta*) by a qualified professional.
- If one or both species are found they will be relocated by a qualified professional to suitable habitat on the Violet Hill property.

Dust Impacts on Breeding Birds and Vegetation

- Ensure all construction personnel are familiar with and implement the 10 point dust control plan on the site plans.
- Ensure all construction personnel are familiar with dust control measure contained in the Trinity Consultants Ontario Inc. Air Quality Assessment Report Violet Hill Pit, Town of Mono, ON, Greenwood Aggregates Company Limited, 2016
- Ensure all construction personnel are familiar with the dust control measures contained in Trinity Consultants Ontario Inc. Best Management Practices for Fugitive Dust, Greenwood Aggregates Company Limited, Violet Hill Pit, Town of Mono, ON, 2018.

Draft
18 August, 2020

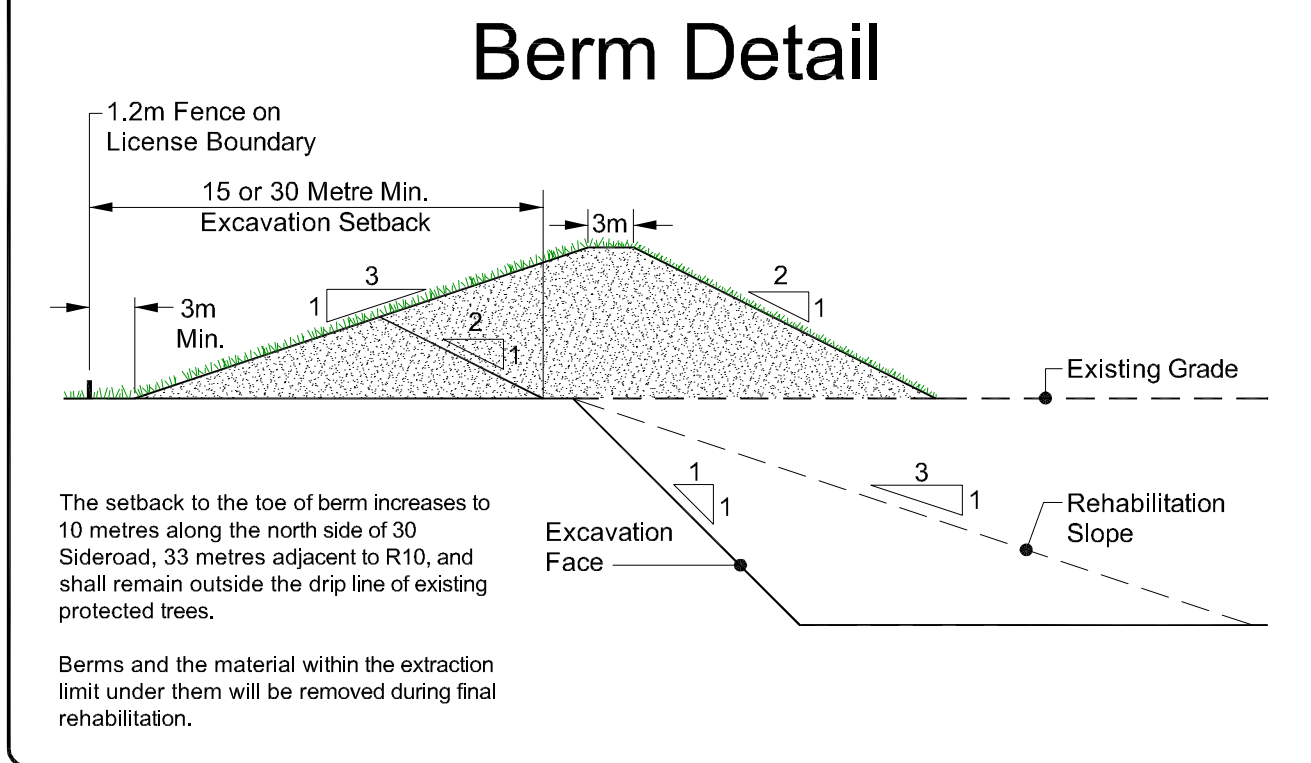

- Notes**
- Berms to be constructed with onsite material or approved topsoil. Topsoil to 0.10m depth and seed. Refer to General Operational Note 19 on Page 2 of 2, Operations Plan. Material from the 4th Line setback to be used in construction of berm along 4th Line.
 - Berm vegetation to be maintained for the duration of the pit.
 - Berms to be constructed to heights shown on this drawing, and may extend into the excavation area.
 - All berms on the north side of 30 Sideroad shall be no closer than 10 metres from the license limit to provide snow storage.
 - 3rd Line buffer planting will be planted prior to commencing work in Area A and will remain after final rehabilitation. If the Third Line Buffer Planting must be disturbed to accommodate berms, it is to be reinstated to its full length as part of rehabilitation.
 - Refer to Page 7 Tree Screen Details for planting plans relating to tree screens other than Third Line. Some flexibility in the planting plan may result from consultation with adjacent landowners at the time of planting.
 - Where tree screens are located on berms, hardwoods shall be planted at the edge of the berm, and will remain after berms have been removed. During removal of berms, driplines and tree roots to be protected for all hardwood trees to be retained.

DRAWN: J.A.R. APPROVED: S.G. FILE: August 2020 Site Plans.dwg PLOTTED: 18 Aug. 2020

ACKNOWLEDGE AND SHALL CARRY ON MY OPERATION IN ACCORDANCE WITH THE SITE PLAN UPON WHICH MY LICENCE IS BASED. GREENWOOD AGGREGATES LIMITED

THIS SITE PLAN IS PREPARED UNDER THE AGGREGATE RESOURCES ACT FOR A CLASS A LICENCE, CATEGORY 3

AMENDMENT NO. 0

SITE PLANS APPROVED BY: JEFFREY A. ROLLINGS

MINISTRY OF NATURAL RESOURCES AND FORESTRY DATE:

No.	DATE	DESCRIPTION	APP'D
Amendments			

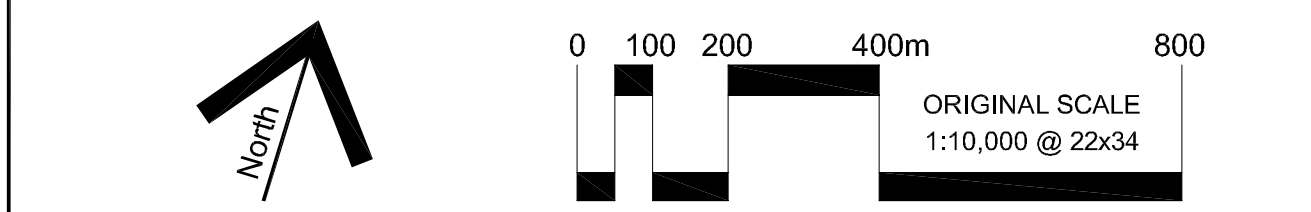

VIOLET HILL PIT
Part Lots 30, 31 & 32, Conc. 4 E.H.S.
Town of Mono
Dufferin County

Page 6 of 7
TREE SCREEN
DETAILS

Legend

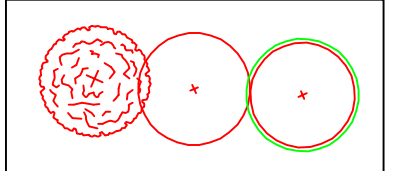
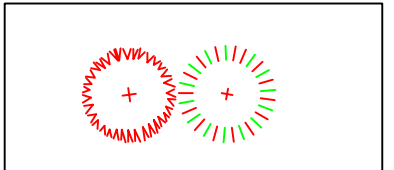
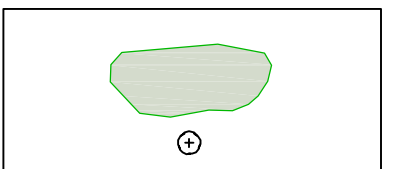
-  Proposed Deciduous Trees
-  Proposed Coniferous Trees
-  Existing Vegetation to Remain

Tree Screen Maintenance Notes:

A tree screen maintenance program will include regular monitoring and watering as required for the first year until the trees are established and thereafter annually in the spring to identify any requirements for fertilization, pest control or watering. Any dead plant material will be replaced yearly in later spring or fall followed by a year of regular monitoring and watering as required.

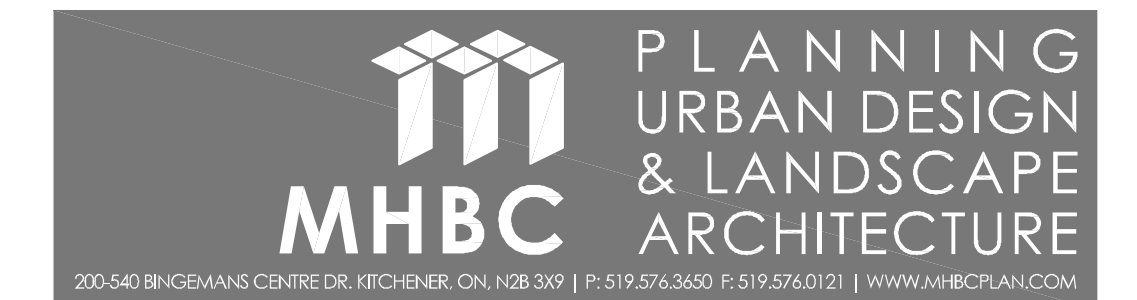

DRAWN: J.A.R.	I ACKNOWLEDGE AND SHALL CARRY ON MY OPERATION IN ACCORDANCE WITH THE SITE PLAN UPON WHICH MY LICENCE IS BASED.	THIS SITE PLAN IS PREPARED UNDER THE AGGREGATE RESOURCES ACT FOR A CLASS A LICENCE, CATEGORY 3
APPROVED: S.G.	GREENWOOD AGGREGATES LIMITED	
FILE: Aug 2020 Site Plans.dwg	PER: _____ DATE: _____	
PLOTTED: 18 Aug. 2020	SITE PLANS APPROVED BY: _____	
AMENDMENT NO. 0	MINISTRY OF NATURAL RESOURCES AND FORESTRY	JEFFREY A. ROLLINGS
	DATE: _____	

No.	DATE	DESCRIPTION	APP'D
Amendments			

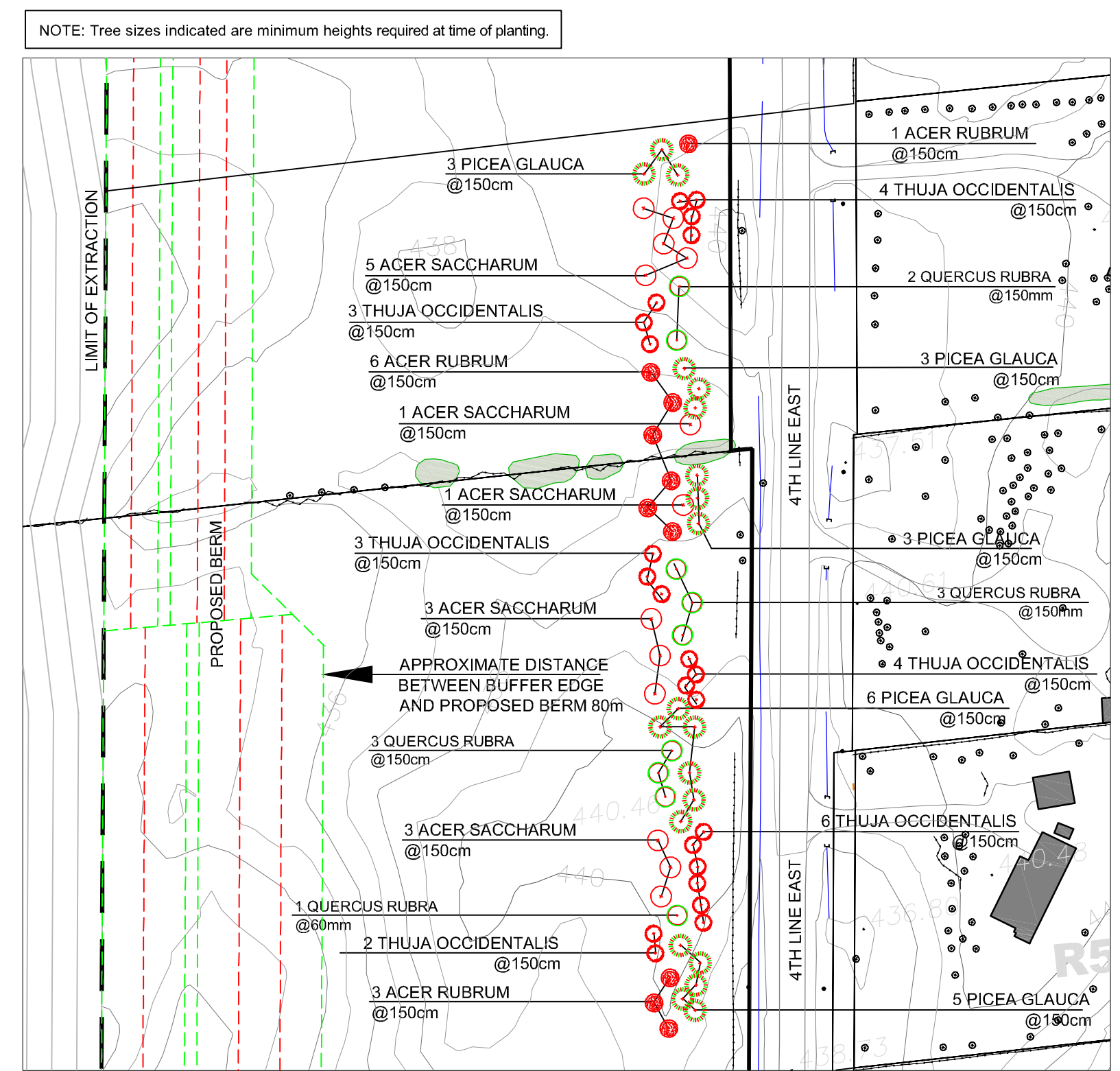
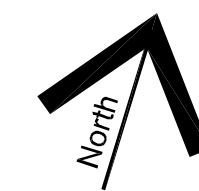

4th Line East - R3-5 Tree Screen

1:1250

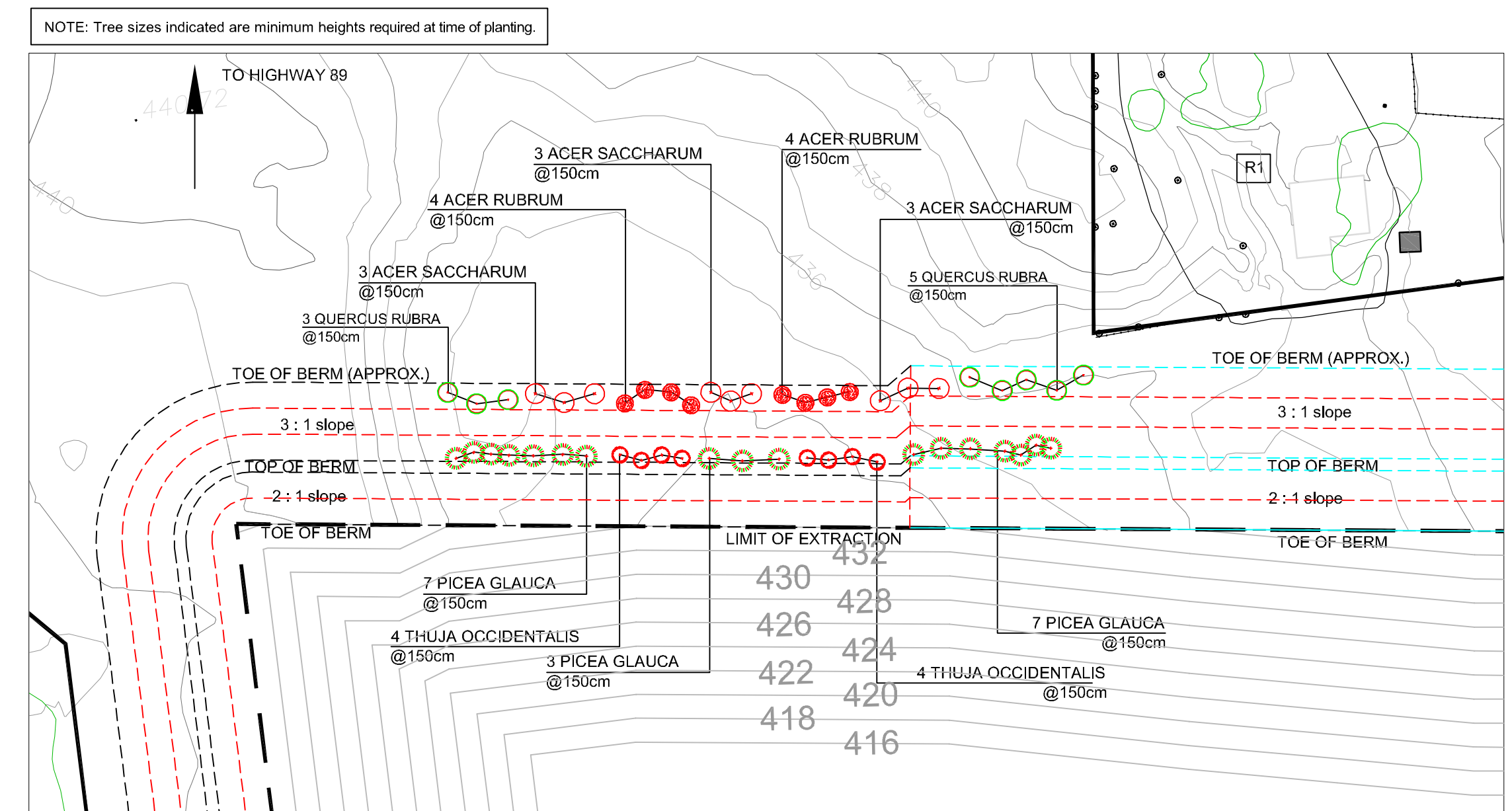

R1 Receptor on Hwy 89 - R1 Tree Screen

1:1250

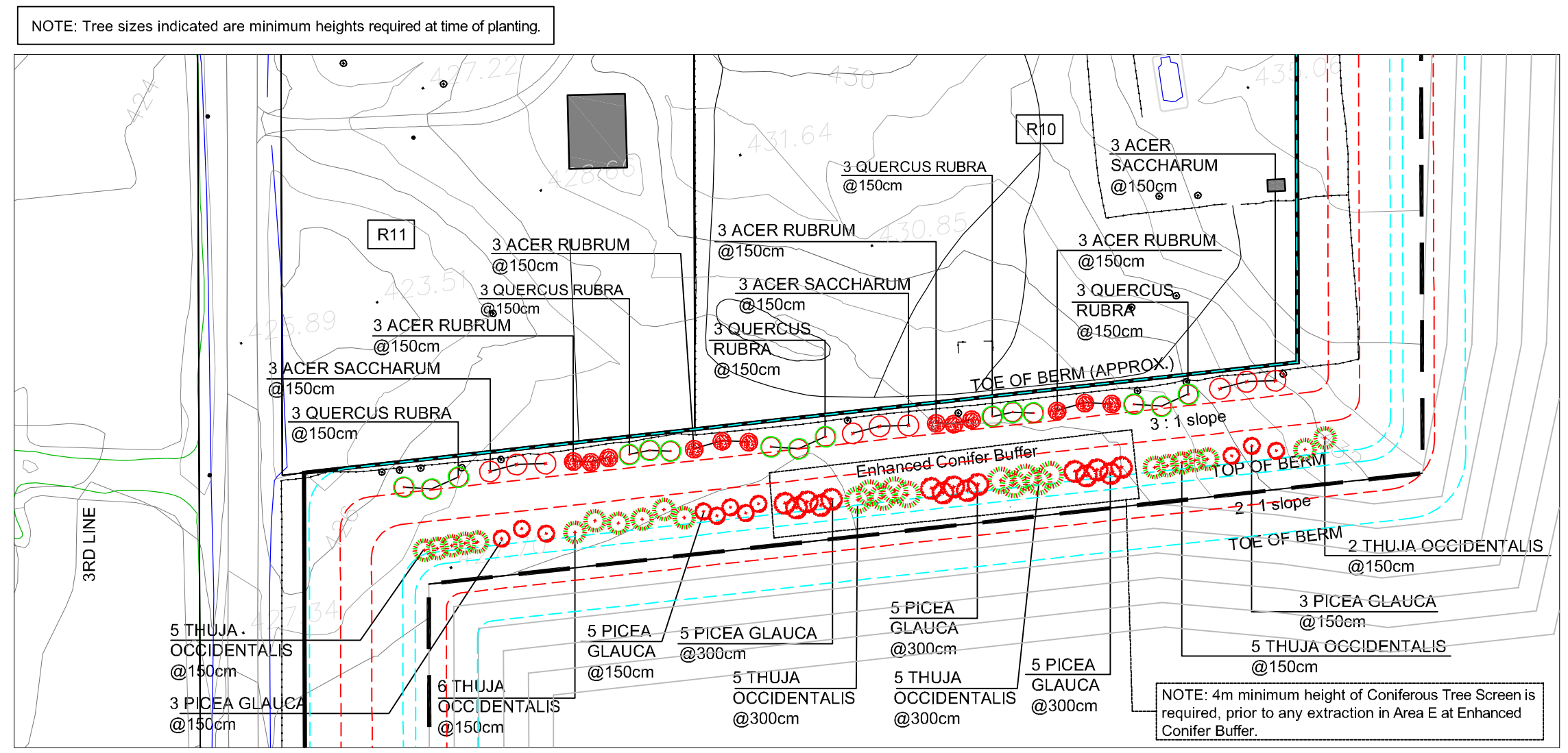

R10-11 Tree Screen

1:1250

Draft
18 August 2020

Complaints Procedures

Greenwood Construction Company Limited, Greenwood Ready Mix Limited and Greenwood Aggregates Company Limited will hereinafter be referred to as "Greenwood".

1. Preface

- The following procedure applies to complaints directly related to services and processes of Greenwood.
- Staff shall treat complaints as confidential and protect complainant's privacy.
- Review of complaints is fair, impartial and respectful of parties involved.
- Complainants are advised of their options to escalate their complaint if they are dissatisfied with treatment or outcome.
- Complainants are provided clear and understandable reasons for how decisions on the complaint were made.
- Updates are provided to complainants during review processes.
- Complainants are used to assist in improving services, policies and procedures.

2. Guiding Principles

- It is in the interest of all parties that complaints are dealt with promptly and resolved as quickly as possible.
- Staff shall treat complaints as confidential and protect complainant's privacy.
- Review of complaints is fair, impartial and respectful of parties involved.
- Complainants are advised of their options to escalate their complaint if they are dissatisfied with treatment or outcome.
- Complainants are provided clear and understandable reasons for how decisions on the complaint were made.
- Updates are provided to complainants during review processes.
- Complainants are used to assist in improving services, policies and procedures.

3. Types of Complaints

Definition: A complaint is an expression of dissatisfaction about the service, actions, or lack of action by a Greenwood business unit or staff. Complaints may relate to the actions of an individual or to a Greenwood policy, process or procedure.

- Examples include but are not limited to:
 - A perceived failure to do something agreed to do;
 - A failure to observe policy or procedures;
 - An error made by staff; or
 - Unfair or discourteous actions/statements by staff;
 - Anyone personally affected can submit a complaint and it will be reviewed in accordance with this procedure.

4. How a Complaint is Made

- A complaint may be received verbally (in person or telephone) or in writing (received by hand delivery, mail, fax or email).
- A complaint may be received by an individual acting on another person's behalf.

5. Complaint Review and Escalation Process

The Greenwood complaint procedure uses a 3 stage escalation process:

- If Greenwood's staff person is uncertain about how to interpret or handle an issue raised by a complainant, they should request the assistance of available management staff.
- Complaints may be accelerated through the escalation process depending on the nature of the issue and judgement of staff.
- Upon any escalation, staff informs the complainant of the manager's name and contact information.

First Stage - Informal Review

- Effort will be made to solve verbal complaints immediately to the satisfaction of the complainant without need for a formal written complaint.
- When receiving a verbal complaint directly, staff will listen and understand the complaint, and may attempt to resolve it.
- Frontline staff automatically and immediately refer the verbal complaint to the manager on duty when:
 - The complainant requests the complaint be referred to a manager;
 - The verbal complaint is about conduct of a staff person, and/or significant disciplinary action is a possible outcome;
 - The complainant is unusually upset, extremely angry or threatening;
 - The verbal complaint cannot be resolved by the frontline staff because it is outside their specific delegation or area of expertise; or
 - It is of a serious nature such as alleged controversial conduct, illegal conduct, or there is a threat of legal action.
- All written complaints are referred to the appropriate manager.

Second Stage - Management Review

- All written complaints begin at the second stage.
- All complaints about conduct of frontline staff begin at the second stage.
- The manager acknowledges receipt with the complainant in a timely manner.
- The manager reviews the complaint, and may attempt to resolve the complaint immediately.
- If required, the manager conducts a formal review of the complaint to determine its validity and explore a resolution (See Formal Review Process below).
- Management staff may request a verbal complainant to put the complaint in writing, especially if it involved a serious or complex matter. If the complainant declines to complete the form, the manager should record details as described by the complainant.
- For all verbal and written complaints requiring formal review, the manager indicates to the complainant when they will contact them with a resolution or update.

Third Stage - Owner Review

- Where the complainant is dissatisfied with the decision of the manager, the manager refers the complaint to the owner.
- The owner may attempt to resolve the complaint immediately, or may conduct a formal review (See Formal Review Process below)

6. Formal Review Process

- A formal review process may be conducted during the second and third stages. The formal review may include:
 - Discussions with the complainant to clarify the complaint, confirm common understanding, clarify outcome sought, or explain complaint procedures
 - Discussion with staff involved.
 - Review of background information such as policies and procedures, previous written communications and other documentation.
 - Obtain and review other expert opinions or perspectives
- At each stage of escalation, it should be determined whether the formal review to-date has been adequate.

7. Notice of decision and Resolution

- Written complaints receive a written notice of decision unless otherwise requested by a complainant.
- Verbal complaints receive written or verbal notice at manager's discretion or as requested by the complainant
- If formal review determines that the complaint is justified, the complainant is notified of corrective action to be taken and any remedy proposed.

8. Unresolved Complaints

If complainant remains unsatisfied at the end of this procedure, the complainant is advised as to further steps they may pursue outside of Greenwood.

9. Signage

Signage at the pit entrance will warn truck drivers of school buses, to drive safely, prohibit use of engine brakes, and to not turn southbound on 3rd Line or east/west on 30th Sideroad except for local deliveries. Signage will also include the Company name and contact information, and require no queuing on 3rd Line.

Measures to Control or Minimize Fugitive Dust

Paved Roads and Entrance Ways

The internal haul route extending from the public road to the scales on the site will be paved and recycled asphalt will be laid on the remainder of the internal route. The following measures shall be used to control and minimize fugitive dust from the internal paved roads:

- The Pit will have one (1) point of entry/exit, which will be paved and well maintained during operations. The entry/exit point is extending 500 m east of 3rd Line E.
- The Pit shall have the capability to spray water or other approved dust suppressants as deemed necessary by the Site Foreman on paved surfaces on-site, as well as roads near the site entrance as needed.
- The actual application rate shall vary, depending on surface moisture conditions and traffic levels, and shall be triggered whenever the scale operator or Site Foreman observes trailers producing a trailing cloud of dust greater than 1/3 of a trailer length.
- Haul routes shall be maintained during Pit operations, to ensure that loose fine material on the haul route surface is minimized.
- To prevent spillage and air entrainment during transport of aggregates, the aggregate loads shall be covered during transport on the internal unpaved roads.
- Any spillage or material deposited on the paved roads shall be removed promptly.
- Regular sweeping of the paved roads will be conducted as required, at the discretion of the Site Foreman, to ensure that visible loose fine material of the haul road surface is minimized.
- Trucks and other mobile equipment shall reduce speed as necessary to reduce trailing dust clouds. The maximum speed will be 35 km/hr.

Unpaved Roads

The internal haul routes at the Site beyond the paved route are unpaved. The following measures shall be used to control and minimize fugitive dust from the internal unpaved roads:

- A truck or trailer-mounted tank will be located on site at all times and shall be equipped with a spray bar to deliver water evenly over the haul route surface.
- At the discretion of the Site Foreman, an alternative MOE/CPIUS-EPA approved dust suppressant may be used should water prove insufficient to control dust emissions. Environmentally hazardous compounds such as waste oil shall not be used as a dust suppressant.
- Dust suppressant supply (water or alternative) shall be available to allow the tanker truck to fill and apply the full payload each hour, if necessary, during dry conditions.
- The actual application rate shall vary, depending on surface moisture conditions and traffic conditions, and shall be triggered whenever the Site Foreman or scale operator observes trucks producing a trailing cloud of dust greater than 1/3 of a trailer length.
- Haul routes shall be maintained (i.e. re-graded) approximately monthly during May to October, to ensure that loose fine material on the haul route surface is minimized.
- Trucks and other mobile equipment shall reduce speed as necessary to reduce trailing dust clouds. The maximum speed will be 35 km/hr.
- The internal roads shall be clearly delineated to limit traffic to the established haul roads that have been maintained. Limiting the trucks away from unmaintained areas of the site is intended to minimize disturbance of unmaintained areas.
- To prevent spillage and air entrainment during transport of aggregates, the trucks carrying aggregate loads shall be covered during transport on the paved and unpaved roads.
- Disturbed areas of unpaved roads shall be stabilized to the extent possible with rollers or other similar equipment.

Wind Erosion of Exposed Stockpiles

- Extraction shall be reduced or suspended if the condition of the active extraction face is dry and dusty and the wind is directed toward a residence at a speed sufficient to cause widespread visible erosion of the open face.
- Water shall be applied to stockpile material that are dry and dusty when the wind is directed toward a residence at a speed sufficient to cause widespread visible emissions.
- Stockpiles shall be maintained to avoid steep sides or faces.
- Disturbance of storage piles shall be minimized where feasible. For active stockpiles, the disturbed area shall be minimized to the extent possible.

Aggregate Crushing, Screening & Washing Plants

- Where the Site Foreman deems necessary, the processing plants shall be equipped with a water spray system. The actual water application rate shall vary, being adjusted as needed to reduce visible dust emission.
- Water for the spray system will be provided from the sump or settling pond.
- The spray-bars will be triggered whenever the Site Foreman or scale operator observes visible dust emissions.
- Where possible, the height of lifts and discharge distances to the top of the stockpile will be kept to a minimum.
- Conveyor drop heights shall be minimized to the extent possible to reduce spillage and provide windbreak.
- Conveyor belts shall be cleaned periodically to remove entrained material.

Truck Loading and Transportation

Truck loading will be suspended if the Site Foreman or scale operator observes the material to be dry and dusty and the wind is sufficient to cause wide-spread visible emissions with plumes directed towards the residences.

The highest point of the material loaded into a truck shall not exceed the vehicles tray walls unless it is covered.

Wind Erosion of Exposed Faces

Extraction shall be suspended if the condition of the extraction face is dry and dusty and the wind is sufficient to cause wide-spread visible erosion of the open face with plumes directed off-site.

Aggregate stockpiles will be located on the Pit floor in close proximity to the extraction face or in the stockpile area.

Wind forecasts shall be monitored regularly for heavy winds during this phase of the operation to anticipate the need for these measures and allow for next day planning.

Measures to Control or Minimize Fugitive Dust, continued

IMPLEMENTATION

Schedule

All control measures are to be in place prior to extraction commencing in the Pit. Control measures shall remain in place so long as the Pit remains in operation.

Implementation Plan

The following outlines how the Best Management Practices Plan (BMPP) shall be implemented, including training of facility personnel:

- The BMPP shall be kept on file at the scale house;
- Training on new and existing operating procedures shall be provided to relevant staff;
- Refresher training shall be provided at a minimum of once every 2 years;
- The Pit management shall communicate the BMPP to responsible supervisors, who shall ensure staff are following operating procedures defined in the BMPP;
- The Site Foreman shall be responsible for ensuring the BMPP is followed;
- Management shall ensure BMPP is reviewed annually; and
- The staff shall follow the BMPP procedures.

INSPECTION AND MAINTENANCE

Maintenance

The following outlines the details regarding the inspection and maintenance procedures that shall be employed at the site:

- The water spray system for the processing plant will be inspected when in use;
- Haul routes shall be inspected daily, or more regularly as dictated by wind conditions and truck traffic. The haul routes shall be maintained on a regular basis, as previously indicated, based on the inspection, the wind conditions and the truck traffic.
- Prior to the operation of the processing plants, the water spray systems should be inspected, and pond water levels shall be inspected to ensure adequate water supply;

Identification of Problems

The Site Operator shall be informed of any issues that arise from inspections performed. Operations may be curtailed if dust control equipment is not adequately performing.

MONITORING AND RECORD KEEPING

Visual inspection for dusty conditions in areas of emission sources identified in the BMPP shall occur at a minimum of twice daily during dry weather and once per day otherwise. Records shall be made each time the following events occur:

- Dust suppressant is applied to paved and unpaved haul routes;
- Unpaved haul routes are maintained;
- Water sprays are used at the processing plant;
- Wet or vacuum-sweeper drives and cleans paved surfaces;
- Heavy dust plumes are observed; and,
- A complaint is received.

All records will be kept onsite in a logbook.

In the event of a dust complaint, the complaint will be directed to the Site Supervisor, who will follow the protocols outlined in the Greenwood Complaints Procedures document, which is kept on-site.

The Pit will enact an action plan concerning its operations in response to a complaint, as detailed in the following section.

RESPONSE TO COMPLAINTS

Complainants are requested to identify the location of the incident as well as the time of day that it was detected and any other relevant information. All dust complaints shall be forwarded to the Site Foreman and recorded in the logbook as identified in the previous section.

The Site Foreman shall ensure the following actions:

- Conduct a site survey to identify sources of visible dust contributing to the complaint;
- Create a record of this survey;
- Determine weather conditions (both current and at the time that the complaint was made); and
- Report on all on-site activities at the time the complaint was made.

If the information collected from the survey procedures indicates that Pit is not the source of the dust complaint, the complainant shall be notified of this finding. Documentation supporting this response mechanism (site survey record and wind station readings at the time of the complaint) shall be provided to the complainant upon request. The Site Foreman or other Pit staff shall respond to all complaints within 24 hours with a phone call to the complainant.

If it is determined that the complaint is related to Pit activities, the following response procedures shall be followed, in the order provided below:

Level 1 - Inspection and Correction of Operations

The Site Foreman shall ensure that all elements of the BMPP are being followed. Control measures such as spraying or watering shall be increased or operations may be curtailed, as required.

Level 2 - Review of the BMPP

If the Level 1 response does not adequately resolve the source of the dust complaint, the BMPP shall be reviewed for additional control measures.

Level 3 - Operational Modifications

If the Level 2 response does not adequately resolve the source of the dust complaint, the Pit shall commit to making physical changes to the facility to address the source of the dust emissions. Such changes may include, but are not limited to additional enclosures, relocation of equipment, or additional paving.

All appropriate approvals under provincial requirements shall be obtained.

Draft
18 August, 2020



VIOLET HILL PIT

Part Lots 30, 31 & 32, Conc. 4 E.H.S.
Town of Mono
Dufferin County

Page 7 of 7 NOTES

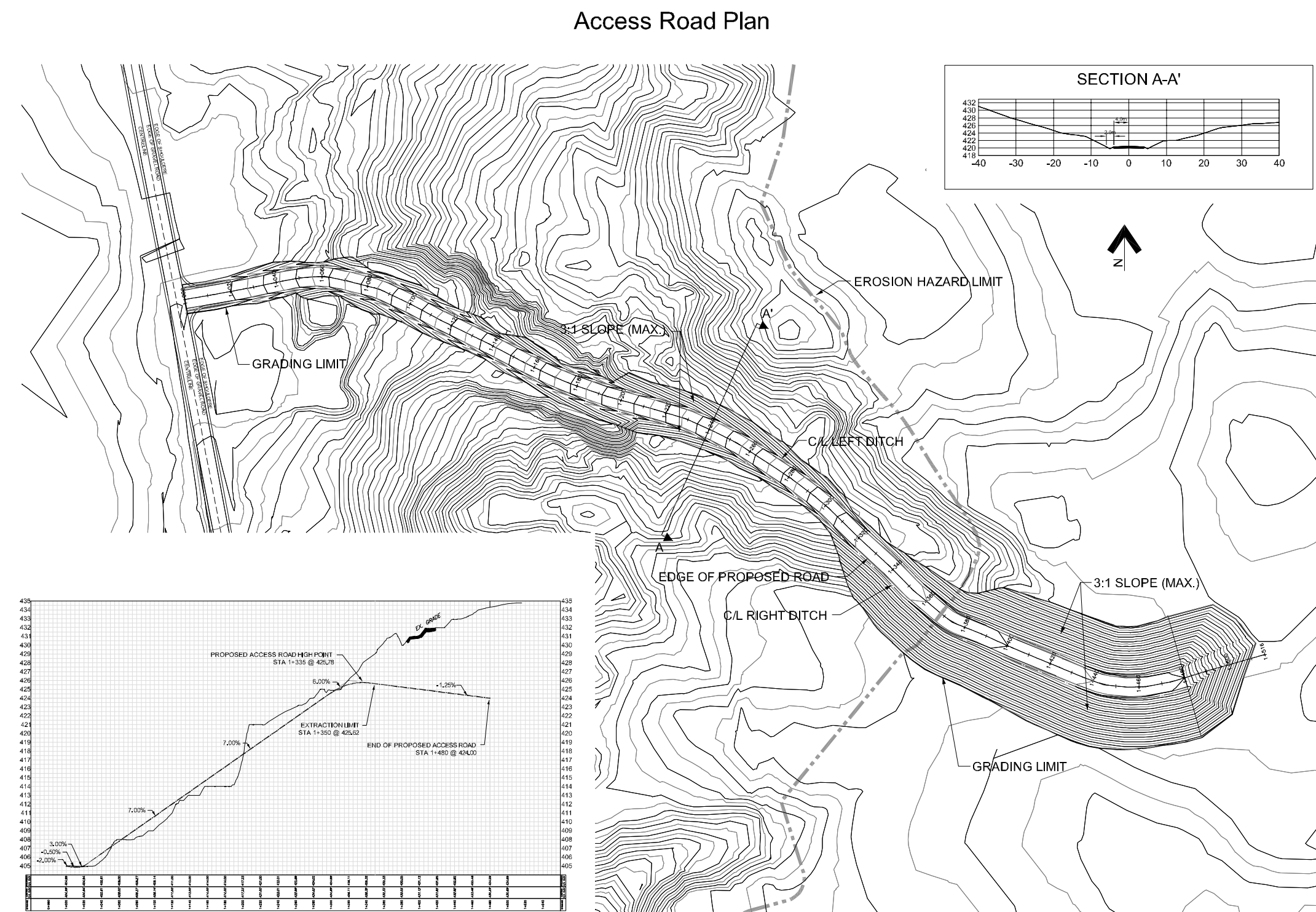

Sediment and Erosion Control Plan will be designed to the satisfaction of the municipality and submitted at the time of final design for Third Line.

DESIGN BY C.C. Tatham & Associates Ltd 1:2,000

DRAWN: J.A.R.	I ACKNOWLEDGE AND SHALL CARRY ON MY OPERATION IN ACCORDANCE WITH THE SITE PLAN UPON WHICH MY LICENCE IS BASED.	THIS SITE PLAN IS PREPARED UNDER THE AGGREGATE RESOURCES ACT FOR A CLASS A LICENCE, CATEGORY 3
APPROVED: S.G.	GREENWOOD AGGREGATES LIMITED	
FILE: August 2020 Site Plans.dwg	PER: _____ DATE: _____	
PLOTTED: 18 Aug. 2020	SITE PLANS APPROVED BY:	JEFFREY A. ROLLINGS
	MINISTRY OF NATURAL RESOURCES AND FORESTRY	DATE: _____
	DATE: _____	

No.	DATE	DESCRIPTION	APP'D
		Amendments	
